

# Efficient. Intuitive.

*Streamlining revision procedures.*

**TRULIANT®**

Truliant Revision System



# TRULIANT®

With the demand for total knee arthroplasty continuing to grow, we know you are challenged to deliver excellent clinical outcomes with ever greater efficiency.

The Truliant® Knee System is a high performance, comprehensive platform that offers solutions to address clinical challenges in primary and revision total knee replacement. Leveraging Exactech's core principles, Truliant applies advanced design philosophies and surgical technologies to help you deliver reproducible clinical outcomes in a streamlined procedure.

---

## Reproducibility

- Comprehensive range of implants, including augments, cones, stems and insert options
- Easy-to-use instrumentation allows for simple flexion/extension gap management
- ExactechGPS provides a high level of accuracy and precision<sup>1</sup> and supports advanced ligament balancing strategies



## Efficiency

- Streamlined technique reduces number of surgical steps to simplify operating room workflow
- Intuitive instrumentation features easy-to-read laser markings and is designed to provide visual, audible and tactile feedback
- Supports a straightforward conversion technique when revision implants are required for complex primary arthroplasty
- Personalized workflows and step-by-step visual guidance with ExactechGPS

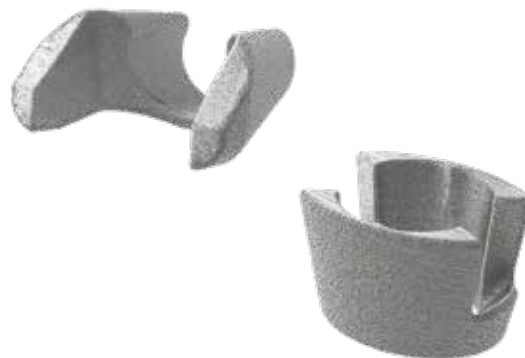

## Alignment

- Instrumentation is designed to ensure alignment relative to mechanical/anatomical axis
- Advanced instrumentation is designed to restore the natural joint line for consistent bone preparation
- Supports accurate placement of implants with 360-degree offset options
- ExactechGPS provides real-time feedback of anatomical and mechanical alignment and resection validation with augmentable capabilities

<sup>1</sup> Data on file at Exactech