

EXACTECH | EXTREMITIES

Operative Technique



equinox[®]

**Platform Fracture Stem
Shoulder System**

For Use in the United States Only

TABLE OF CONTENTS

PLATFORM FRACTURE STEM SYSTEM SPECIFICATIONS	2
HEMIARTHROPLASTY	4
OVERVIEW TECHNIQUE	4
DETAILED OPERATIVE TECHNIQUE.....	6
Pre-Operative Planning.....	6
Hemiarthroplasty Surgical Approach	8
Post-Operative Rehabilitation	19
Post-Operative Range Of Motion	19
FRACTURE REVERSE	20
OVERVIEW TECHNIQUE	20
DETAILED OPERATIVE TECHNIQUE.....	22
Pre-Operative Planning.....	22
Fracture Reverse Surgical Approach	23
CLOSURE	38
POST-OPERATIVE REHABILITATION.....	38
REVISING A HEMIARTHROPLASTY TO A REVERSE	39
EQUINOXE IMPLANT SCOPE.....	40
EQUINOXE PLATFORM STEM INSTRUMENT LISTING.....	42
REFERENCES.....	50



EQUINOXE® PLATFORM FRACTURE STEM DESIGN TEAM:

Pierre-Henri Flurin, MD

Surgical Clinic of Bordeaux, Merignac (France)

Sean Grey, MD

Orthopaedic Center of the Rockies

Richard B. Jones, MD

Southeastern Sports Medicine

Howard D. Routman, DO

Atlantis Orthopaedics

Thomas W. Wright, MD

University of Florida

Joseph D. Zuckerman, MD

NYU Langone Orthopedic Hospital

PLATFORM FRACTURE STEM SYSTEM SPECIFICATIONS

(All dimensions in millimeters)

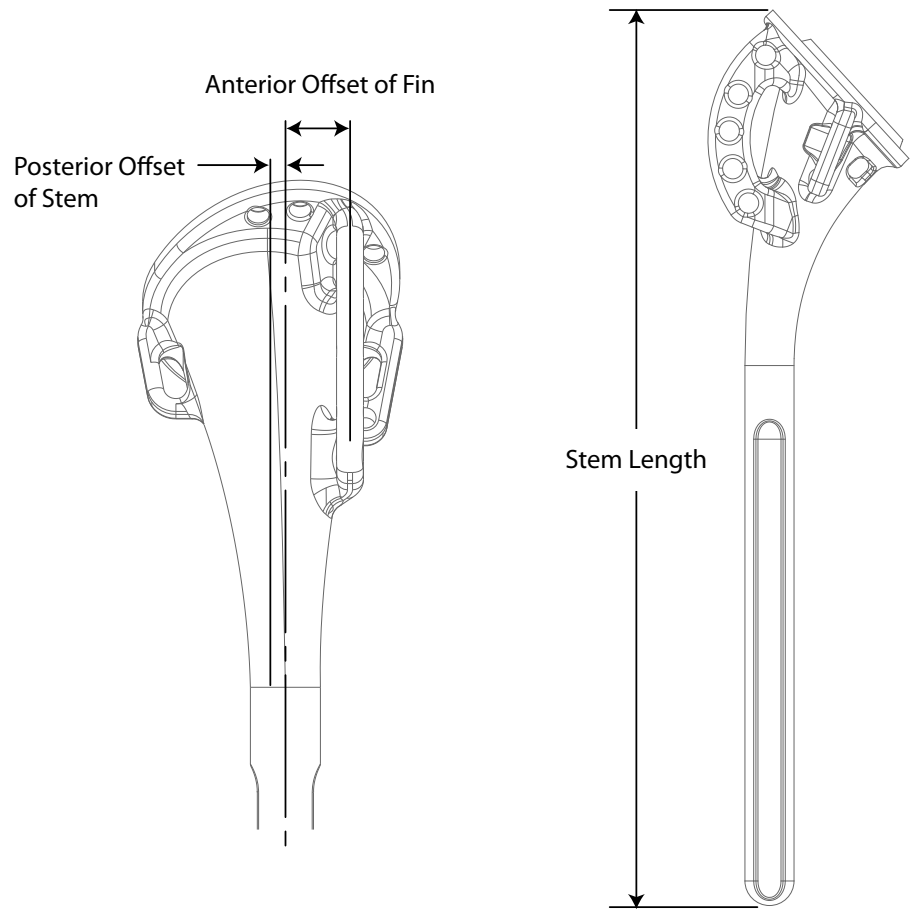

FRACTURE STEM

Distal Diameter	Length	Sides	Material	Surface Finish			Inherent Posterior Offset	Anterior Offset of Fin
				Tuberosity Beds	Remainder of Stem	Suture Holes		
6.5	120 & 200	Rights & Lefts	Ti-6Al-4V	16 grade grit blast	Satin finish High bright polish	Rounded to avoid breakage	1.8	6.0
8.5	140						1.8	7.5
10.5							1.8	7.5
12.5							1.8	7.5

HUMERAL HEADS

Diameter (mm)	Height (mm)			Offset (mm)	Material
	Short	Tall	Expanded		
38	16	19		0	Co-Cr
41	16	20		0	
44	17	21		1.5	
47	18	22	26	1.5	
50	19	23	27	1.5	
53	20	24	28	1.5	

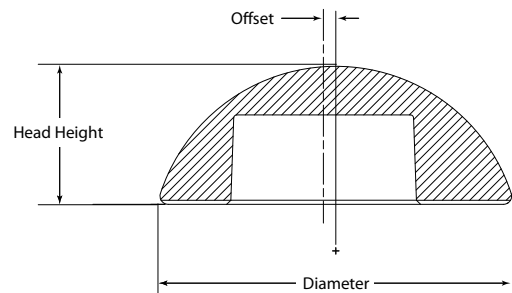

HUMERAL TRAY/HUMERAL LINER OFFSET COMPARISONS

	+0mm Humeral Liners (Standard & Constrained)	+2.5mm Humeral Liners (Standard & Constrained)
+0 Humeral Tray	0	2.5
+5 Humeral Tray	5	7.5
+10 Humeral Tray	10	12.5
+15 Humeral Tray*	15	17.5

* Special order.

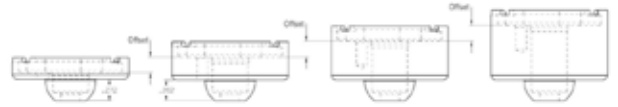

HUMERAL LINER DEPTH COMPARISONS

	Standard Liner Depth (+0mm and +2.5mm)	Constrained Liner Depth (+0mm and +2.5mm)
38 Humeral Liner	8.5	12.0
42 Humeral Liner	8.8	12.6

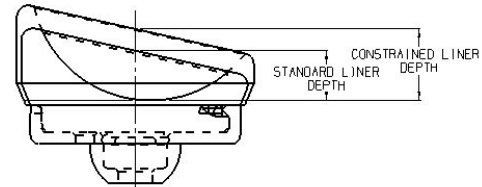

135 DEGREE AND 145 DEGREE HUMERAL LINER COMPARISONS

	Humeral Liner Angle	Combined Angle with Humeral Stem
135 Degree Humeral Liner	2.5°	135°
145 Degree Humeral Liner	12.5°	145°

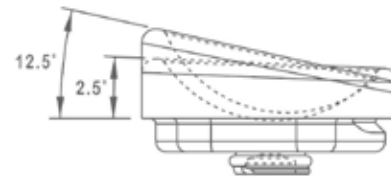

COMPRESSION SCREWS

Diameter	Length	Color
4.5	18	White
	22	Black
	26	Orange
	30	Blue
	34	Red
	38	Green
	42	Yellow
46	Purple	

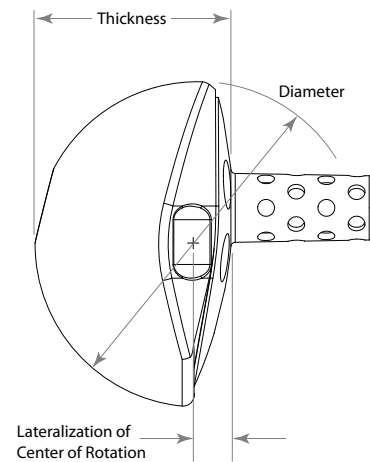
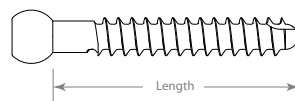

GLENOSPHERE/GLENOID PLATE

	Diameter	Thickness	Average Lateralization of Center of Rotation
38 Glenosphere	38	23.1	2
42 Glenosphere	42	25.1	
46 Glenosphere*	46	27.1	2

* special order

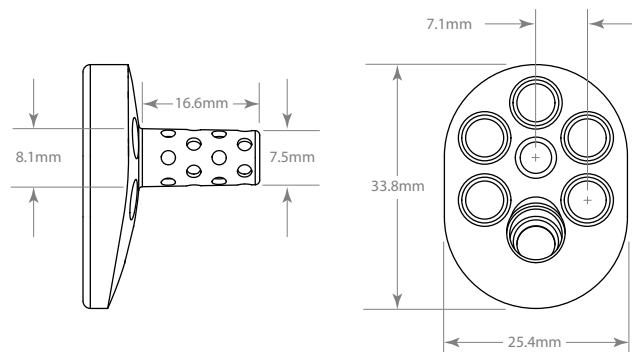

HEMIARTHROPLASTY OVERVIEW TECHNIQUE

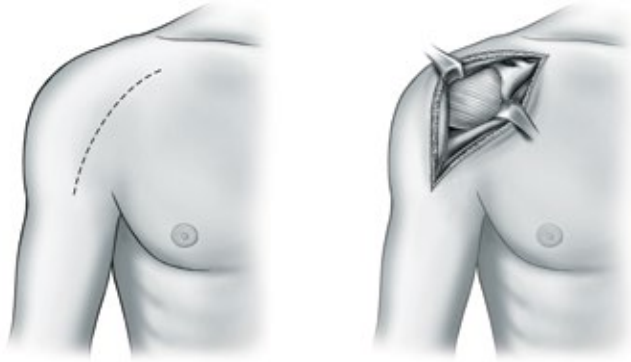

A Incision and Exposure



B Insert Reamer



C Align Fin to Bicipital Groove



D Insert Fracture Stem Trial



E Maintain Height



F Attach Replicator Plate Trial



G Align Humeral Head Trial

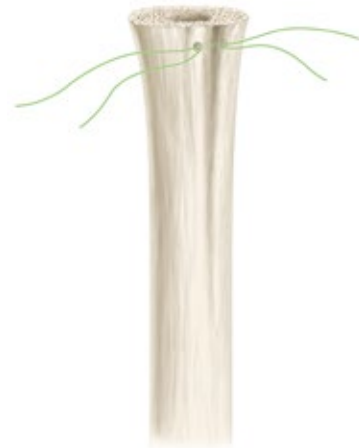

H Drill Pilot Holes for Attaching Vertical Sutures



I Lock Torque-Defining Screw



J Insert Final Prosthesis

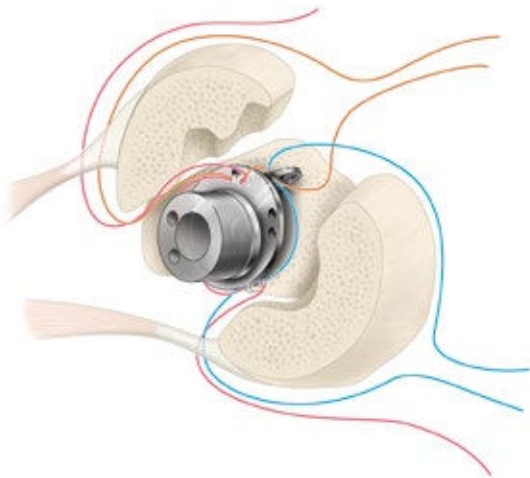

K Tuberosity Reattachment

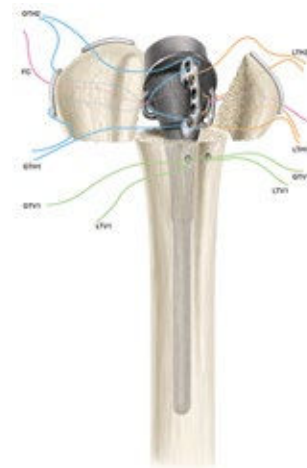

L Place GT and LT Horizontal Sutures (GTH and LTH) and Final Cerclage (FC)

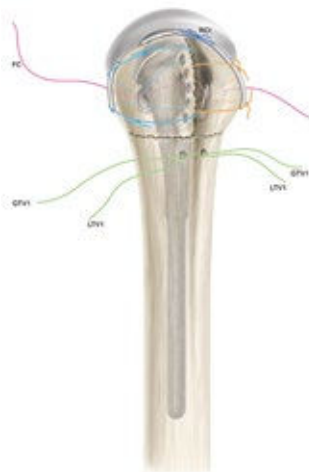

M Tie Horizontal Sutures then Place and Tie Cuff Interval Suture (RCI)

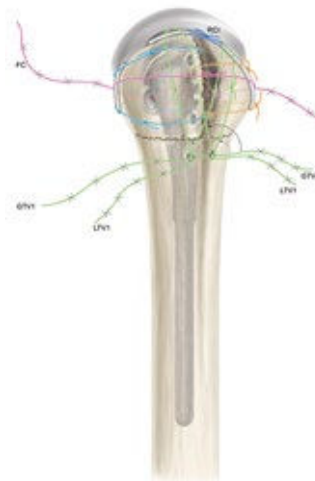

N Tie LT Vertical Suture and then Tie GT Vertical Suture



O Tie Final Cerclage

DETAILED OPERATIVE TECHNIQUE

PRE-OPERATIVE PLANNING

SURGICAL TEMPLATE

The decision to proceed with proximal humeral replacement should reflect a careful consideration of both injury and patient factors. An important injury factor is the degree of tuberosity displacement; it indicates the degree of soft-tissue injury and is associated with an increased risk of osteonecrosis. The degree of comminution and bone quality also are important factors that may prevent optimal fixation.

Important patient factors include the age and functional needs of the patient. Additionally, the presence of pre-existing functional deficits in the involved extremity must be considered in the decision to proceed with a reconstructive procedure. Patients must be able to participate in a structured post-operative rehabilitative program, which is essential for a successful outcome.

Establishing the appropriate humeral head height and humeral length is a challenge in reconstructing four-part proximal fractures. The most common pre-operative method to evaluate humeral head height in the fractured shoulder is by comparison to the contralateral humerus in an A/P radiograph.

Once the appropriate head height is established, mark the A/P radiograph with the anticipated location of the humeral head using the Equinox surgical templates (*Surgical Template*). Define the height level of the humeral stem relative to the fracture line. Additionally, assess the appropriate stem diameter relative to the canal diameter; each stem has a 0.5mm cement mantle when used with the appropriate reamer. It is also important to know that the fin holes on the trial correspond to the fin holes on the definitive implant.

PATIENT POSITIONING

The patient should be placed on an operating table in a supine position. The head of the operating table should be elevated approximately 30 degrees in a modified beach chair position. A small bolster is placed behind the involved scapula. The patient should be moved to the side of the table so that the upper extremity can be placed into maximum extension without obstruction by the operating table. Alternatively, a Captain's chair or similar positioning device can be used for proper patient positioning. The patient should be secured to the operating table to minimize any changes in position intra-operatively. The entire upper extremity should be prepped and draped to allow full mobility during the procedure.

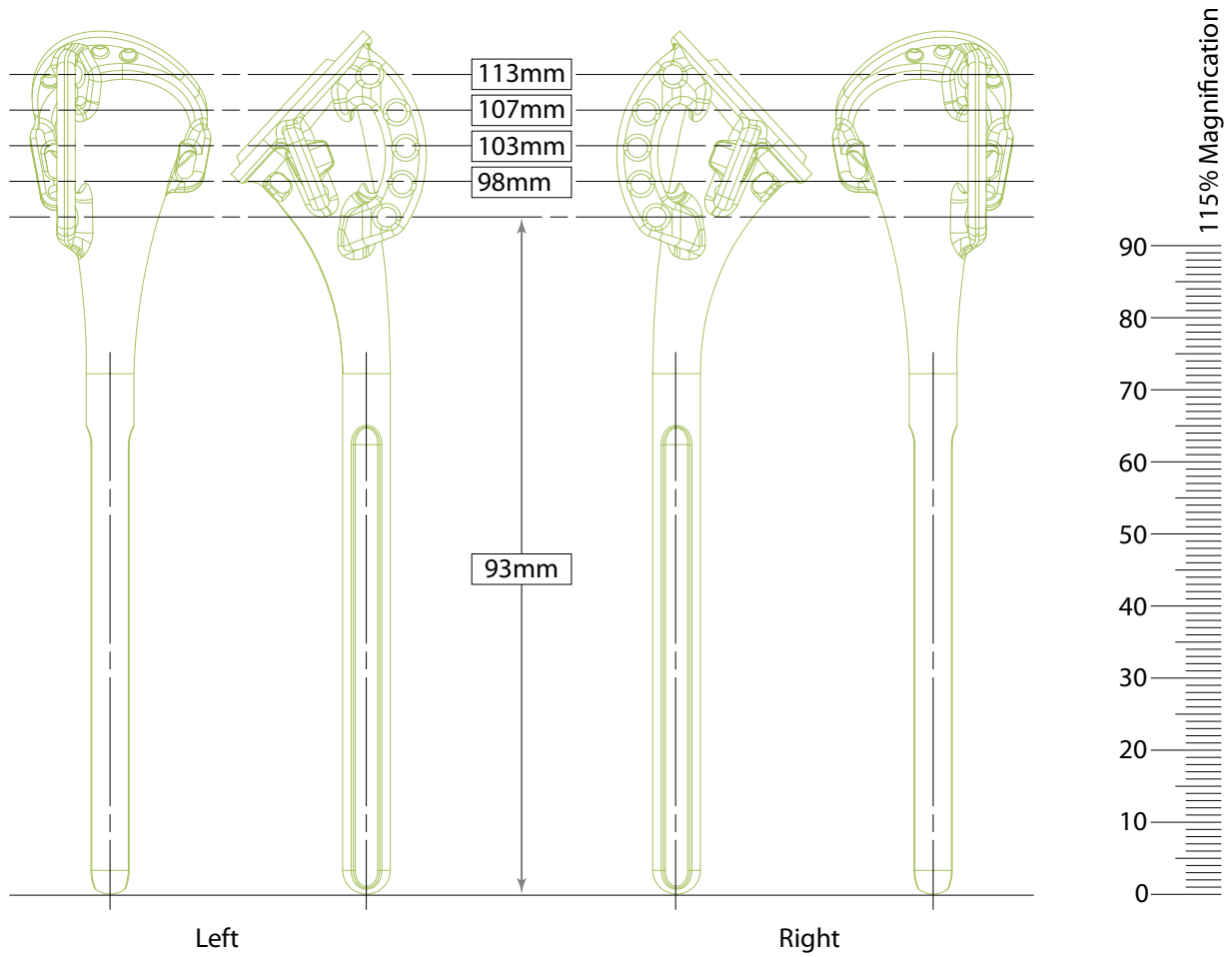

Surgical Template

X-Ray Template 6.5mm Platform Fracture Stem

DETAILED OPERATIVE TECHNIQUE

HEMIARTHROPLASTY SURGICAL APPROACH

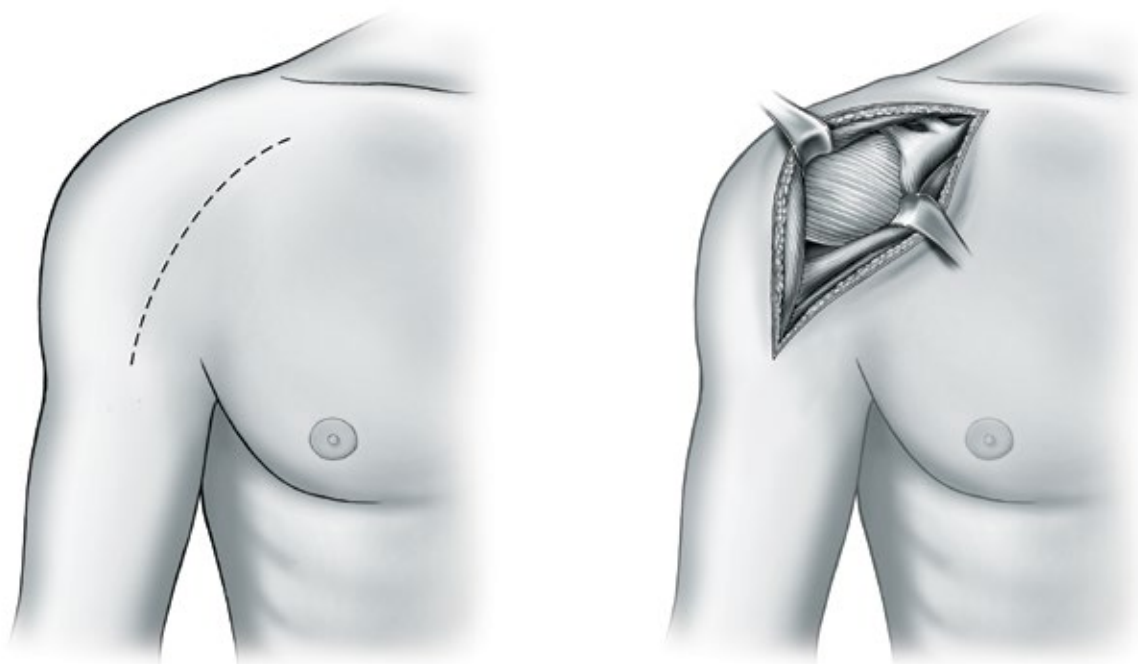

Figure 1
Incision and Exposure

SURGICAL APPROACH

A straight deltopectoral incision is made beginning just lateral to the tip of the coracoid process and extending distally and laterally to the insertion of the deltoid. The subcutaneous tissues are divided and medial and lateral flaps are elevated to expose the deeper muscular layers (*Figure 1*).

The deltopectoral interval is identified by localization of the cephalic vein. The cephalic vein is usually retracted laterally with the deltoid muscle. In some instances the cephalic vein is more easily retracted medially with the pectoralis major. In either case, care should be taken to preserve the cephalic vein throughout the procedure.

The subdeltoid space is mobilized, as is the pectoralis major. The conjoined tendon muscles are identified and the clavipectoral fascia is divided at the medial edge of the

conjoined tendon muscles. The fracture hematoma is usually evident after dividing the clavipectoral fascia. The conjoined tendon muscles and the pectoralis major are retracted medially and the deltoid is retracted laterally. This can be most easily accomplished with the use of a self-retaining type of retractor. After the fracture hematoma has been evacuated, the deeper structures can be visualized. The biceps tendon should be identified and tagged with a suture. The biceps tendon provides an orientation to the greater and lesser tuberosities.

A straight deltopectoral incision is made beginning just lateral to the tip of the coracoid process and extending distally and laterally to the insertion of the deltoid. The subcutaneous tissues are divided and medial and lateral flaps are elevated to expose the deeper muscular layers (*Figure 1*).

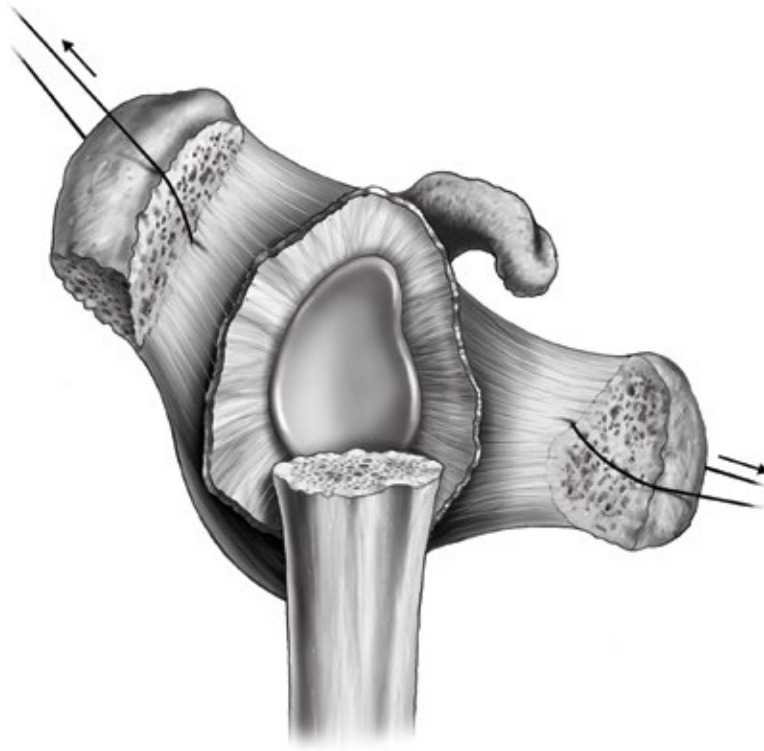

Figure 2
Exposed Glenoid Face

The deltopectoral interval is identified by localization of the cephalic vein. The cephalic vein is usually retracted laterally with the deltoid muscle. In some instances the cephalic vein is more easily retracted medially with the pectoralis major. In either case, care should be taken to preserve the cephalic vein throughout the procedure.

The subdeltoid space is mobilized, as is the pectoralis major. The conjoined tendon muscles are identified and the clavipectoral fascia is divided at the medial edge of the conjoined tendon muscles. The fracture hematoma is usually evident after dividing the clavipectoral fascia. The conjoined tendon muscles and the pectoralis major are retracted medially and the deltoid is retracted laterally. This can be most easily accomplished with the use of a self-retaining type of

retractor. After the fracture hematoma has been evacuated, the deeper structures can be visualized. The biceps tendon should be identified and tagged with a suture. The biceps tendon provides an orientation to the greater and lesser tuberosities.

The lesser tuberosity is located medial to the biceps tendon and the greater tuberosity is located superiorly and laterally. Each tuberosity should be tagged with a #2 suture for easier mobilization. These sutures should be placed at the tendon insertion site, because this is generally the most secure area; placement of the sutures through the tuberosity itself can result in fragmentation. The lesser tuberosity is mobilized and retracted medially while the greater tuberosity is retracted laterally and superiorly to allow visualization of the articular segment (*Figure 2*).

DETAILED OPERATIVE TECHNIQUE

HEMIARTHROPLASTY SURGICAL APPROACH



Figure 3
Insert Reamer

In four-part fractures, the articular segment is generally devoid of soft-tissue attachments and is easily removed. The coracoacromial ligament should be identified at its coracoid attachment and followed to its acromial attachment. When possible, preserve the ligament because of its potential contribution to anterior-superior stability.

With the articular segment removed and the tuberosities retracted, the glenoid articular surface should be inspected. In most situations, the articular surface of the glenoid is intact. It should be visualized to confirm the absence of pre-existing degenerative changes or acute injury. The axillary nerve can usually be palpated at the anterior-inferior aspect of the glenoid. Continuity of the axillary nerve can be confirmed by the “tug test,” which consists of palpation of the nerve as it comes around the humeral neck on the underside of the

deltoid and as it passes inferior to the glenoid. A gentle back and forth “tugging” motion confirms its continuity. At this point, the humerus should be placed in extension to expose the proximal portion of the humeral shaft.

HUMERAL PREPARATION

Sequentially ream the intra-medullary canal beginning with the 7mm **Fluted Reamer**, until endosteal cortical contact is achieved (**Figure 3**). To avoid over-reaming, keep in mind the anticipated stem diameter based on pre-operative templating. When using the 7mm Reamer, the notch in the flutes indicate the appropriate depth to guarantee the stem can fit distally. The top of the flutes should be used as the depth marker for all other sizes. This ensures the stem can be fully seated for the larger sizes (the 8.5mm, 10.5mm and 12.5mm fracture stems are 20mm longer than the 6.5mm).



Figure 4
Align Fin to Bicipital Groove



Figure 5
Insert Fracture Stem Trial

The use of a cement restrictor is based on personal preference; however, an appropriately sized cement restrictor will improve distribution. If a cement restrictor will be used, it is advantageous to place the cement restrictor in the humeral canal after reaming and before the **Fracture Stem Positioning Device** is attached to the humerus to avoid interference with the K-wires.

Fracture Stem Trialing

Select the **Fracture Stem Trial** based on the last Reamer fully seated. Ensure that the appropriate stem side is chosen (e.g. “Right” or “Left”).

Retroversion—Distal Portion of Bicipital Groove (Visible)

Retroversion is established by aligning the anterior-lateral fin of the Fracture Stem Trial with the posterior aspect of the distal bicipital groove (**Figure 4**). Computational analysis of data from our anatomic study of cadaveric humeri

demonstrated that placing the fin in the posterior aspect of the distal bicipital groove established retroversion as accurately as the traditional technique of using a pre-selected fixed angle relative to the epicondylar axis.¹

Retroversion—Distal Portion of Bicipital Groove (Not Visible)

Typically, the distal portion of the bicipital groove is visible but in cases when it is not, the standard technique of retroverting the implant at 20 degrees relative to the forearm should be used. In this case, the surgeon must attach the **Primary Stem Inserter** to the Fracture Stem Trial and screw in the **Retroversion Handle** as shown in Figure 4. By aligning the Retroversion Handle with the forearm, the Fracture Stem Trial will be placed in 20 degrees of retroversion (**Figure 5**). A mark should be placed on the humeral cortex that corresponds to the anterior-lateral fin of the implant to maintain 20 degrees of retroversion during implantation.

DETAILED OPERATIVE TECHNIQUE

HEMIARTHROPLASTY SURGICAL APPROACH

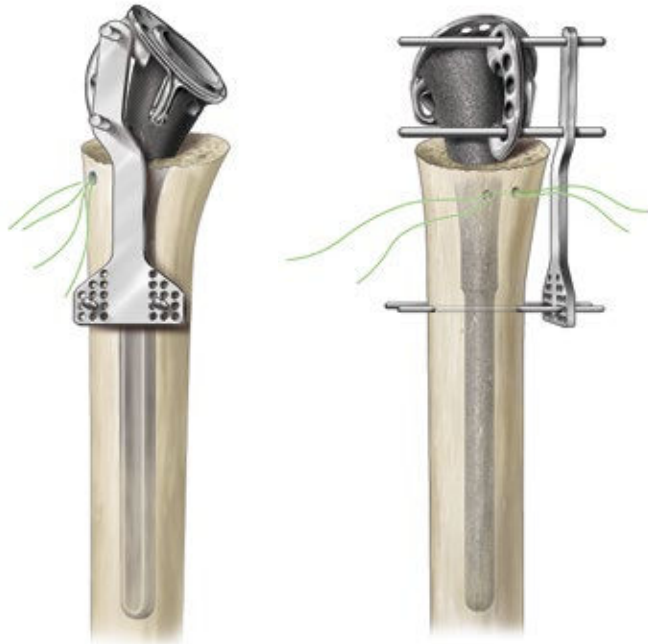

Figure 6
Maintain Height



Figure 7
Attach Replicator Plate

HUMERAL HEAD TRIAL AND TRIAL REDUCTION

Humeral Stem Height

Place the Fracture Stem Trial into the intra-medullary canal at the desired height as determined pre-operatively (e.g. templating contralateral shoulder) or based on the surgeon's intra-operative judgment (see "Tips for Establishing Height Intra-Operatively"). Using the Fracture Stem Positioning Device, slide the two pins through the top and bottom suture holes in the anterior-lateral fin of the Fracture Stem Trial. Then place two K-wires (0.062 inches) into the humeral shaft to stabilize the Fracture Stem Positioning Device to the bone.

The goal is to secure the K-wires in the cortical bone so choose the widest holes that still align with the humerus. Selecting a middle row allows the surgeon to make +/- 4mm height adjustments during the trial reduction by sliding the Fracture Stem Positioning Device off the K-wires and repositioning it (*Figure 6*).

Attaching the Replicator to the Plate Trial

Attach the 0mm Fixed Angle Replicator Plate Trial to the trial stem and hand-tighten the captured screw with the Torque Screw Removal Tool (*Figure 7*).



Figure 8

Align Humeral Head Trial

Humeral Head Trial

As a starting point, choose a **Humeral Head Trial** based on the size of the patient's anatomic Humeral Head. The eccentric position of the Humeral Head should be chosen based on the anatomy and/or soft-tissue tension as assessed during trial reduction of the tuberosities (*Figure 8*).

Tips for Establishing Height Intra-Operatively

- PULL-DOWN TEST — With Humeral Head Trial in place, pull arm distally and the top of the head should be at the top of the glenoid
- FINGER TEST — One finger should fit between the greater tuberosity and the acromion
- Piece back the tuberosities to snugly fit under the Humeral Head
- If there is no medial bone comminution and no metaphyseal bone on the head fragment, then the calcar of the Humeral Stem can be placed directly on this medial bone, which will then determine head height.

Trial Reduction

Trial reduction is a critical part of the procedure, because it defines the parameters needed to obtain a stable construct. After the Humeral Head is reduced onto the glenoid, the greater and lesser tuberosities are pulled into position. The biceps tendon is allowed to fall between the tuberosities. Traction on the tuberosity sutures not only maintains the tuberosities in position, but also provides a more accurate assessment of stability. Self-retaining retractors should be relaxed when assessing soft-tissue tension.

DETAILED OPERATIVE TECHNIQUE

HEMIARTHROPLASTY SURGICAL APPROACH

HUMERAL HEADS

Diameter (mm)	Height (mm)			Offset (mm)	Material
	Short	Tall	Expanded		
38	16	19		0	Co-Cr
41	16	20		0	
44	17	21		1.5	
47	18	22	26	1.5	
50	19	23	27	1.5	
53	20	24	28	1.5	

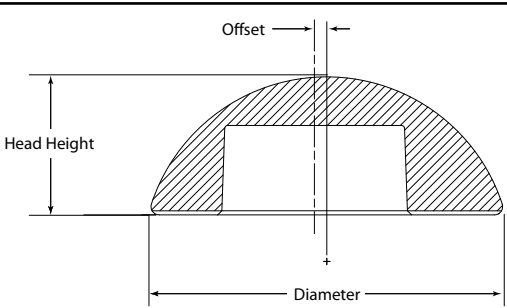

The diagram illustrates a cross-section of a humeral head. A vertical dashed line represents the centerline. The horizontal distance from this centerline to the center of the head is labeled 'Offset'. The vertical distance from the base of the head to the top of the head is labeled 'Head Height'. The horizontal distance across the base of the head is labeled 'Diameter'.

Figure 9
Humeral Head Scope

Assessment of posterior, inferior and anterior stability should be performed by translating the Humeral Head in each direction. Up to 50 percent of posterior and inferior translation of the Humeral Head on the glenoid is acceptable; however, anterior translation should not exceed 25 percent. If translation is greater, the position of the Humeral Stem should be re-evaluated to confirm that it has not subsided or rotated within the canal.

Varying the thickness of the Humeral Head provides the ability to optimize stability and range of motion (*Figure 9*). If soft-tissue laxity is excessive, a taller Humeral Head may be needed. Conversely, if soft-tissue tension is excessive, a shorter Humeral Head is chosen. In either situation, repeat assessment of stability is required to confirm that the proper

components and position have been chosen. When the proper position and component size are confirmed, the trial prosthesis should be removed. Unless otherwise indicated, the short head will be used in the majority of cases.

REDUCTION WITH DEFINITIVE IMPLANT

Cementing the Fracture Stem

To remove the Fracture Stem Trial, leave the Fracture Stem Positioning Device attached to the humerus and slide the holding pins out of the suture holes in the anterior-lateral fin. Alternatively, if the Positioning Device is not used, the location of the fin can be marked and the height relative to the holes in the fin can be noted and then reproduced with the definitive stem.



Figure 10
Prepared Humeral Shaft



Figure 11a
Lock Torque-Defining Screw on the Back Table Assembly



Figure 11b
Lock the Torque-Defining Screw *in situ*

Two drill holes are placed through the humeral cortex into the intra-medullary canal. These holes should be placed approximately 1.5 to 2cm distal to the level of the surgical neck, and lateral to the bicipital groove. Two #5 non-absorbable sutures are passed through one drill hole into the intra-medullary canal and then out through the second drill hole (**Figure 10**). These vertical sutures are used for tuberosity fixation. The canal is then irrigated copiously and any loose cancellous bone removed.

Place the definitive stem into the **Back Table Assembly**, attach the 0mm Fixed Angle Replicator Plate and lock the Torque-Defining Screw (**Figure 11a**).

Note: When using an offset Replicator Plate, ensure the offset is pointing in the six o'clock position unless anatomic landmarks are available.

Alternatively, the Replicator Plate may be assembled *in situ* (**Figure 11b**).

Formal cement pressurization is avoided to decrease the possibility of humeral-shaft fracture. The intra-medullary canal should be packed with a sponge to obtain adequate drying before cementing. Cement is mixed and injected into the canal with a cement gun.

DETAILED OPERATIVE TECHNIQUE

HEMIARTHROPLASTY SURGICAL APPROACH



Figure 12
Insert Final Prosthesis

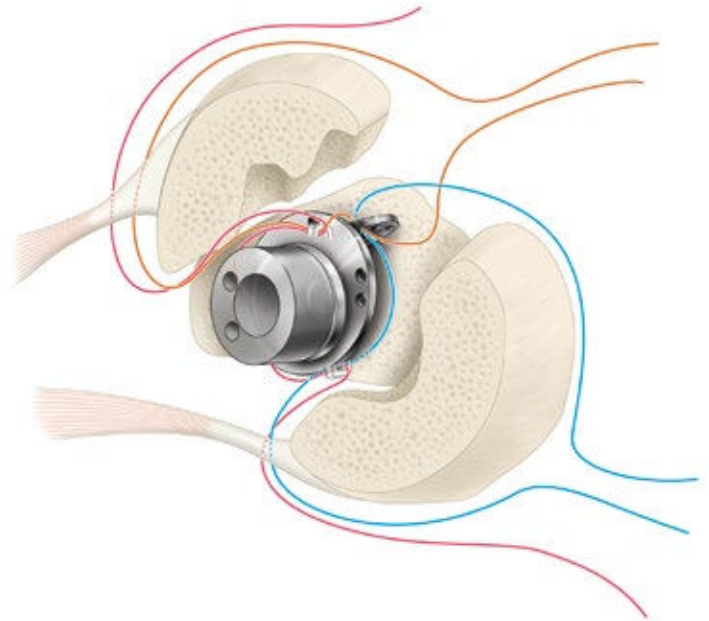

Figure 13
Tuberosity Reattachment

Insert the final prosthesis into the canal and insert the Fracture Stem Positioning Device's two holding pins through the top and bottom holes of the stem's anterior-lateral fin (*Figure 12*). Ensure the two sutures in the humeral shaft remain mobile and that no cement hardens in the posterior suture handle or medial cerclage suture hole. This will ensure that the prosthesis is inserted at the same height and version as the Fracture Stem Trial. When the cement is hardened, make certain the Replicator Plate is dry and free of any debris.

Tuberosity Fixation

Fixation of the tuberosities to the prosthesis and the shaft is critical to the success of the procedure. Proper tuberosity reattachment and secure fixation will enhance the probability of a successful outcome in terms of pain relief, range of motion and overall function. A grafting window is provided in the anterior-lateral fin to allow tuberosity apposition.

Apply cancellous bone from the Humeral Head between the shaft and the tuberosities, and between the tuberosities to facilitate healing and a more anatomic reconstruction. If this is not available, Optecure® bone graft may be used.

Tuberosity Reattachment

The principles of tuberosity fixation include:

1. two horizontal sutures around each tuberosity to pull the tuberosities to the Humeral Stem (*Figure 13*);
2. placement of one longitudinal suture from the shaft to each tuberosity to bring the tuberosities into a position below the prosthetic articular surface and into contact with the humeral shaft; and
3. one final cerclage suture, which cinches the tuberosities together, and to the Humeral Stem, for added stability.

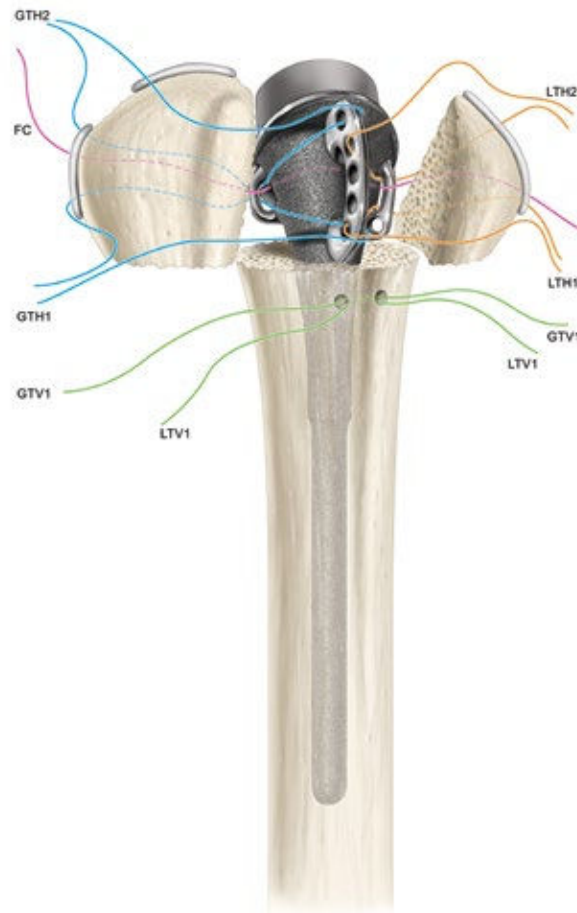

Suturing Technique 1a, b, c

To secure the tuberosities to the Humeral Stem, we recommend heavy #5 non-absorbable sutures. Tuberosity reattachment should be performed with the arm in approximately 20-degrees of abduction and neutral flexion.

Suturing Technique for Right Shoulder

Suturing Technique 1a: To reattach the greater tuberosity, pass two horizontal sutures between the greater tuberosity and Humeral Stem. Pass the first suture (First Horizontal suture for the Greater Tuberosity, GTH1) through the lower portion of the infraspinatus tendon where it inserts into the greater tuberosity, through the posterior handle and through an inferior lateral suture hole of the anterior-lateral fin. Pass the second suture (Second Horizontal suture for the Greater Tuberosity, GTH2) through the upper portion of the infraspinatus tendon where it inserts into the greater tuberosity, through the posterior handle and through a superior lateral suture hole of the anterior-lateral fin.

Suturing Technique 1b: Pass the final cerclage suture through the middle of the infraspinatus tendon, through the posterior suture handle, around the stem through the medial hole of the fracture stem. Next pass the final cerclage through the anterior handle and through the middle of the subscapularis tendon.

Suturing Technique 1c: To reattach the lesser tuberosity, pass two horizontal sutures between the lesser tuberosity and the Humeral Stem. Pass the first suture (First Horizontal suture for the Lesser Tuberosity, LTH1) through the lower portion of the subscapularis tendon where it inserts into the lesser tuberosity, through the anterior handle and through an inferior lateral suture hole of the anterior-lateral fin. Pass the second suture (Second Horizontal suture for the Lesser Tuberosity, LTH2) through the upper portion of the subscapularis tendon where it inserts into the lesser tuberosity, through the anterior handle and through a superior suture hole of the anterior-lateral fin.

DETAILED OPERATIVE TECHNIQUE

HEMIARTHROPLASTY SURGICAL APPROACH

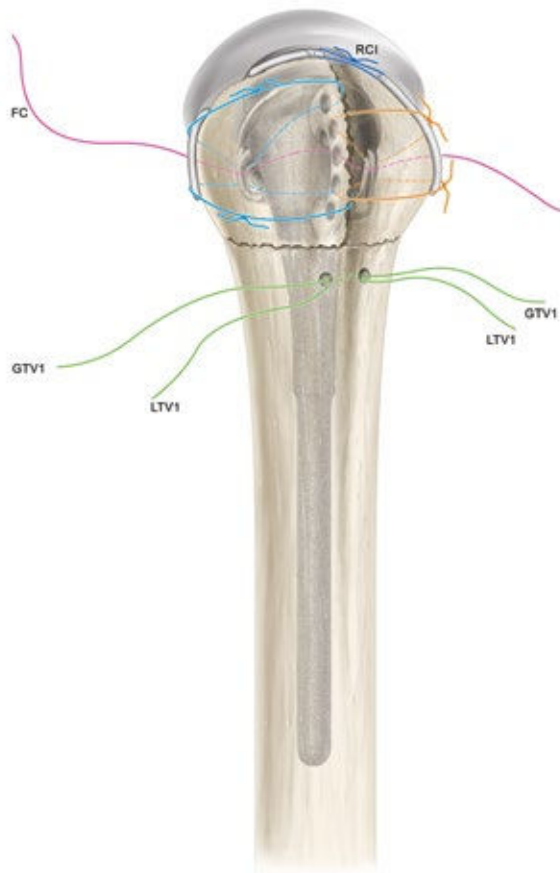

Tying the Sutures

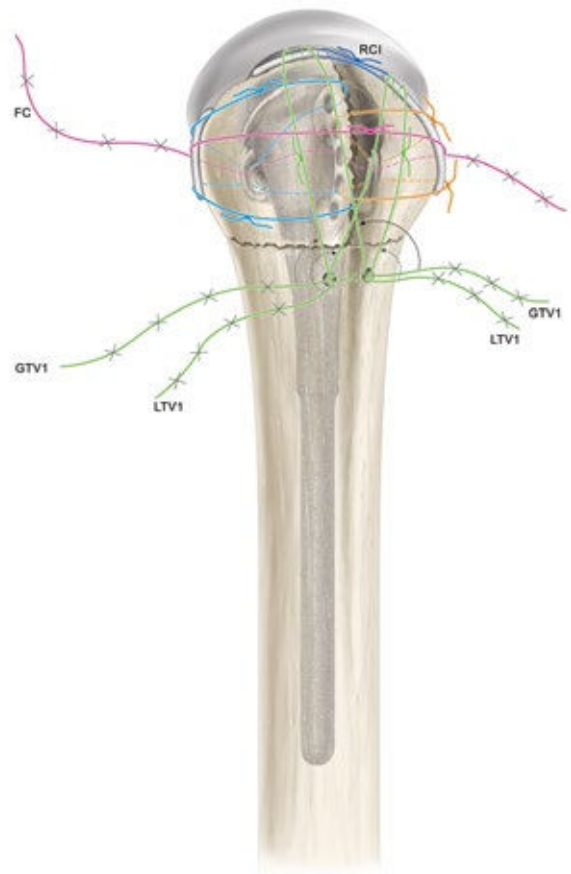

Tying the Sutures 2a, b, c, d

Humeral Head Attachment

The final Humeral Head component is placed on the Humeral Stem in the same orientation established in the trialing phase. Impact the Humeral Head using the Impactor directly in line with the taper to ensure proper engagement of the Morse Taper.

Tying the Sutures

It is important to balance the applied-tension when tying off each suture so as not to displace the tuberosities. First, tie the horizontal sutures for the greater tuberosity when the arm is slightly externally rotated. Second, tie the horizontal sutures for the lesser tuberosity when the arm is placed in neutral rotation.

Tying the Suture 2a: Closure includes repair of the rotator interval with #2 non-absorbable sutures. This repair is performed with the humerus in external rotation to decrease the possibility that rotator interval closure will restrict rotation.

Tying the Suture 2b: Next, pass and tie the vertical suture (LTV1) through the top upper portion of the subscapularis tendon near the rotator interval where it inserts into the lesser tuberosity.

Tying the Suture 2c: Finally, pass and tie the vertical suture (GTV1) through the supraspinatus tendon where it inserts into the greater tuberosity.

Tying the Suture 2d: Once completed, tie the final cerclage.



Humeral Head Attachment

Final Stable Reconstruction

When the tuberosity fixation is completed, the stability of the fixation should be carefully assessed. Range of motion in forward elevation, external rotation, internal rotation and abduction should be performed to determine the specific limits of motion that will be allowed in the post-operative rehabilitation program.

Depending on surgeon preference, a drain may be placed deep into the deltopectoral interval and brought out through the skin distally and laterally. The deltopectoral interval is repaired with an absorbable suture, as is the subcutaneous tissue. Skin closure can be performed with either sutures or staples. A sterile dressing is applied and the upper extremity is placed in a sling.

Radiographs in the operating room are strongly recommended. These should include an A/P view of the shoulder with the humerus in internal rotation (on the chest) and maximum external rotation as defined by the intra-operative assessment. An axillary view is also obtained. These radiographs provide excellent visualization of the position of the prosthesis as well as the position of the tuberosities.

POST-OPERATIVE REHABILITATION

It is recommended to initiate the rehabilitation program on the same day as surgery or on post-operative day one. All patients begin active range of motion of the elbow, wrists and

hand, and passive range of motion of the shoulder. External rotation should be limited based upon the intra-operative evaluation; internal rotation is allowed to the chest. This is important to avoid any excess stress on the tuberosity repair that could compromise healing. Alternatively, some surgeons will not move the shoulder for three to four weeks post-operatively.

POST-OPERATIVE RANGE OF MOTION

Exercises are continued for six to eight weeks. Radiographs are obtained approximately two weeks following surgery to confirm the position of the tuberosities. Additional radiographs are obtained at six to eight weeks following surgery to assess the degree of tuberosity healing. If tuberosity healing is sufficient, the sling is discontinued and an active range-of-motion program is begun. At this time patients are encouraged to use their arm for activities of daily living. Passive range-of-motion is continued with gentle stretching to increase overall range. At eight weeks following surgery, isometric deltoid and internal and external rotator strengthening exercises are begun. Vigorous strengthening exercises are not allowed until active forward elevation of at least 90 degrees is obtained. Most patients can expect continued improvement during the first year following surgery, although most recovery will occur during the first six months.

FRACTURE REVERSE OVERVIEW TECHNIQUE



1A Superolateral Approach



1B Deltopectoral Approach

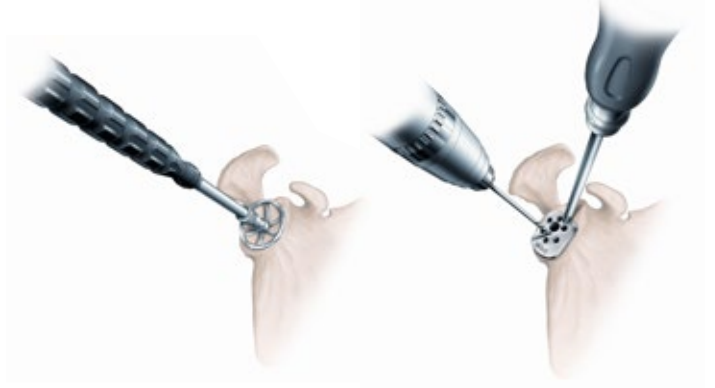

2 Pilot-Tip Option: Drill Reamer Pilot Hole, Ream the Glenoid and Drill Glenoid Plate Hole

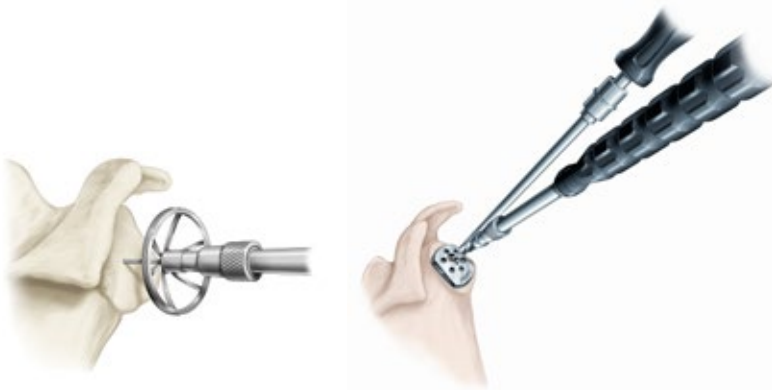

3 Cannulated Option: Insert K-wire, Ream the Glenoid and Drill Glenoid Plate Hole over K-wire



4 Assemble the Glenoid Plate with Bone Graft



5 Insert Glenoid Plate



6 Drill Pilot Holes for Compression Screws



7 Insert Compression Screws

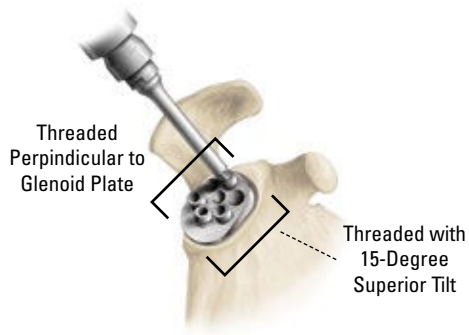

8 Tighten Locking Caps

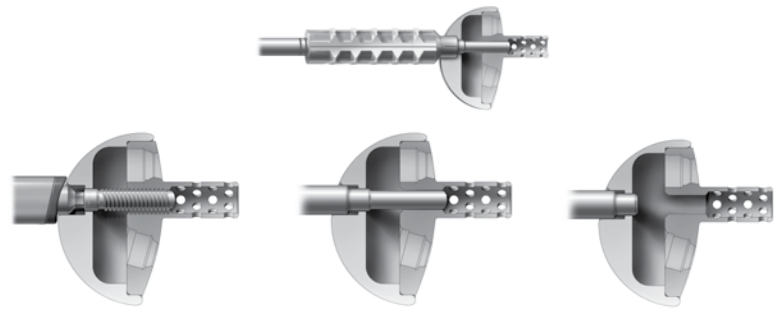

9 Insert Glenosphere Trial



10 Glenosphere Trial



11 Ream Humeral Canal



12 Align Fin to Bicipital Groove



13 Position Trial Stem without Bicipital Groove



14 Maintain Height



15 Attach Humeral Tray Trial to Stem Trial



16 Attach Humeral Liner Trial to Trial Tray



DETAILED OPERATIVE TECHNIQUE

PRE-OPERATIVE PLANNING

After a careful history and physical examination, radiographs should be obtained to assess glenohumeral joint space narrowing, osseous deformities and glenoid wear. A CT scan is helpful to assist in the evaluation of the quality of bone stock and to further evaluate bone deformities that may be present. An MRI may be obtained if further evaluation of the soft tissues is determined to be helpful. To aid in pre-operative planning, radiographic templates are provided for the humeral components and glenoid components to approximate the required size and alignment of the implants.

PATIENT POSITIONING

The patient should be placed on an operating table in a supine position. The head of the operating table should be elevated approximately 30 degrees in a modified beach chair position. A small bolster should be placed laterally behind the involved shoulder. The patient should be moved to the side of the table so that the upper extremity can be placed in maximum extension without obstruction by the operating table. Alternatively, a Captain's chair or similar positioning device can be used for proper patient positioning. The patient should be secured to the operating table to minimize any changes in position intraoperatively. The entire upper extremity should be prepped and draped to allow complete access to the operative area and full mobility during the procedure. Either a deltopectoral or a superiorlateral approach may be used depending on the surgeon's preference and clinical parameters.

SURGICAL APPROACH

Deltopectoral Approach

A straight deltopectoral incision is made beginning just lateral to the tip of the coracoid process and extending distally and laterally to the insertion of the deltoid. The subcutaneous tissues are divided and medial and lateral flaps are elevated to expose the deeper muscular layers.

The deltopectoral interval is identified by localization of the cephalic vein. The cephalic vein is usually retracted laterally with the deltoid muscle. In some instances the cephalic vein is more easily retracted medially with the pectoralis major. In either case, care should be taken to preserve the cephalic vein throughout the procedure.

The subdeltoid space is mobilized, as is the pectoralis major. The conjoined tendon muscles are identified and the clavipectoral fascia is divided at the medial edge of the conjoined tendon muscles. The fracture hematoma is usually evident after dividing the clavipectoral fascia. The conjoined tendon muscles and the pectoralis major are retracted medially and the deltoid is retracted laterally. This can be most easily accomplished with the use of a self-retaining type of retractor. After the fracture hematoma has been evacuated, the deeper structures can be visualized. The biceps tendon should be identified and tagged with a suture. The biceps tendon provides an orientation to the greater and lesser tuberosities.

Superiolateral Approach

A superiolateral incision is made beginning at the anterior edge of the acromion and directed posterolaterally in an oblique direction. Subcutaneous dissection is performed to raise generous flaps medially and laterally. The interval between the anterior and middle portions of the deltoid is identified and this interval is developed superiorly over the top of the acromion. In doing so, the anterior deltoid is detached from its acromial attachment along with the coracoacromial ligament insertion. The interval is developed up to 4cm distally from the acromion to avoid potential injury to the axillary nerve. This provides exposure of the subacromial space, which is usually filled with fibrous and bursal tissue that should be removed to expose the humeral head.

The lesser tuberosity is located medial to the biceps tendon and the greater tuberosity is located superiorly and laterally. Each tuberosity should be tagged with a #2 suture for easier mobilization. These sutures should be placed at the tendon insertion site, because this is generally the most secure area; placement of the sutures through the tuberosity itself can result in fragmentation. The lesser tuberosity is mobilized and retracted medially while the greater tuberosity is retracted laterally and superiorly to allow visualization of the articular segment.

In four-part fractures, the articular segment is generally devoid of soft-tissue attachments and is easily removed. The coracoacromial ligament should be identified at its coracoid attachment and followed to its acromial attachment. When possible, preserve the ligament because of its potential contribution to anterior-superior stability.

With the articular segment removed and the tuberosities retracted, the glenoid articular surface should be inspected. In most situations, the articular surface of the glenoid is intact. It should be visualized to confirm the absence of pre-existing degenerative changes or acute injury. The axillary nerve can usually be palpated at the anterior-inferior aspect of the glenoid. Continuity of the axillary nerve can be confirmed by the "tug test", which consists of palpation of the nerve as it comes around the humeral neck on the underside of the deltoid and as it passes inferior to the glenoid. A gentle back and forth "tugging" motion confirms its continuity. At this point, the humerus should be placed in extension to expose the proximal portion of the humeral shaft.

PREPARING THE GLENOID

Glenoid Exposure

Retractors are provided to aid in glenoid exposure. A Posterior Glenoid Retractor (e.g. **Wolfe Retractor**) should be used to displace the proximal humerus posteriorly. A single- or double-spiked glenoid retractor is then placed anteriorly along the glenoid neck. Hohmann Retractors are placed superiorly and inferiorly around the glenoid.

The glenoid labrum is excised circumferentially to expose the entire surface of the glenoid. Any remaining portions of



the biceps tendon also should be excised. There is often a significant amount of tissue around the glenoid that represents bursal tissue and remnants of rotator cuff tendons. This should be excised to enhance visualization. The superior, anterior and inferior capsule should be released both for exposure and mobilization. A posterior capsular release may be beneficial to allow the proximal humerus to be retracted posteriorly for adequate glenoid exposure.

At this point, the degree and location of glenoid erosion can be visualized. This should be carefully and completely assessed so that glenoid reaming can be performed to provide proper orientation of the glenoid component. Exposure of the glenoid also will be facilitated by use of specific retractors. For a deltopectoral approach, a Posterior Glenoid Retractor is essential. The **Forked Retractor** provided in the instrument set can be useful for this purpose. The

large **Darrach Retractor** provided can also be used. Levering retractors should be placed anteriorly, superiorly and inferiorly to expose the glenoid margins.

When a superior approach is used, the inferior capsular release is particularly important. The Forked Retractor can then be placed inferiorly to retract the proximal humerus posteroinferiorly for glenoid exposure. Levering retractors should be placed anteriorly, superiorly and posteriorly as described.

Note: *While the Equinox Glenoid Plate does not need to be inferiorly tilted or angled, it should not be implanted with a superior tilt. A neutral orientation is ideal.*

DETAILED OPERATIVE TECHNIQUE

FRACTURE REVERSE SURGICAL APPROACH

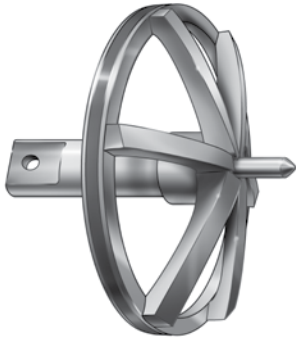

Figure 14a
Pilot-Tip Reamer



Figure 14b
Cannulated Reamer



Figure 15a
Superolateral Approach

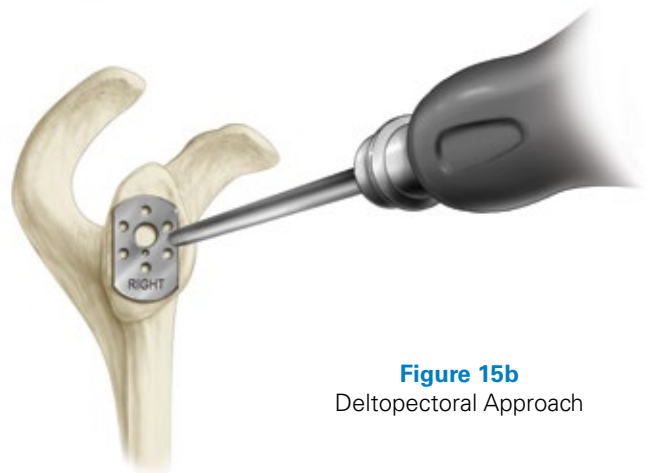

Figure 15b
Deltopectoral Approach

Reaming the Glenoid

The Equinox System provides two options to ream the glenoid: 1) **Pilot-Tip** and 2) **Cannulated Reamers** (*Figure 14a, b*). Cannulated Reamers rotate about a 0.079 inch K-wire and provide the surgeon maximum precision.

Regardless of the reaming option, the first step is to align the **inferior aspect** of the **Modular Glenoid Plate Drill Guide** with the **inferior aspect** of the native glenoid bone after removing any inferior glenoid osteophytes (*Figure 15a, b*). This ensures the glenosphere is properly positioned in a superior-inferior position. Palpate the anterior glenoid neck to determine the angle for glenoid reaming.

Note: Two handle orientations are offered for the two different surgical approaches.

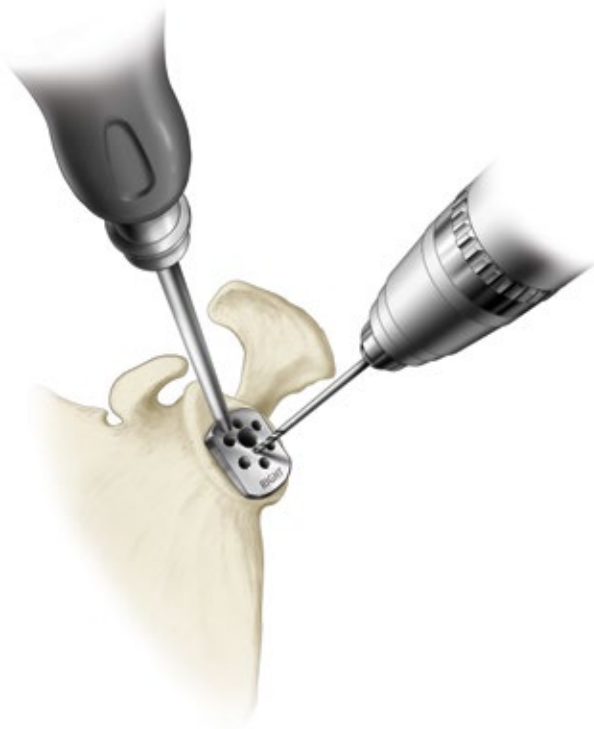

Figure 16
Drill 2mm Pilot Hole



Figure 17
Connect the Modular Glenoid Driver

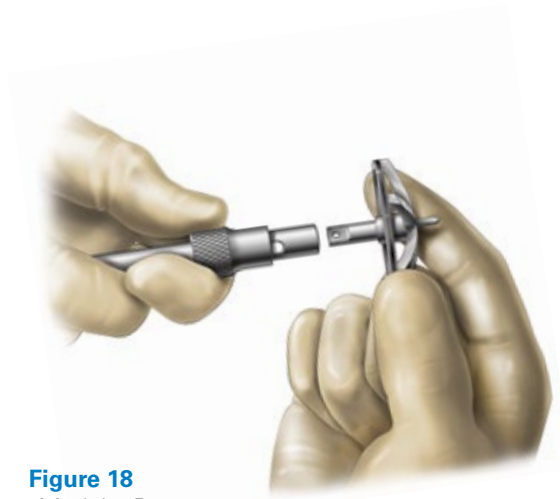

Figure 18
Connect Modular Reverse
Pilot-Tip Reamer to
Glenoid Driver

Pilot-Tip Reamers

If using the Pilot-Tip Reamers, the 2mm pilot hole is drilled to create the central axis for reaming the glenoid (*Figure 16*).

The **Reverse Starter Reamer** is provided for each reamer type to aid the surgeon in initial preparation. Connect the Modular Glenoid Driver to the Powered Hand Piece using a Jacobs® Chuck (*Figure 17*).

Next, connect the appropriately sized **Modular Reverse Pilot-Tip Reamer** to the **Modular Driver** (*Figure 18*).

DETAILED OPERATIVE TECHNIQUE

FRACTURE REVERSE SURGICAL APPROACH

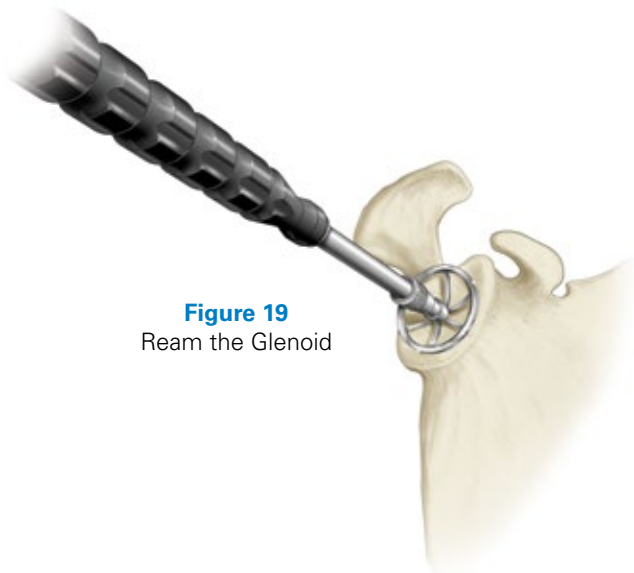

Figure 19
Ream the Glenoid



Figure 20
Connect Modular Reverse
Cannulated Reamer to
Glenoid Driver

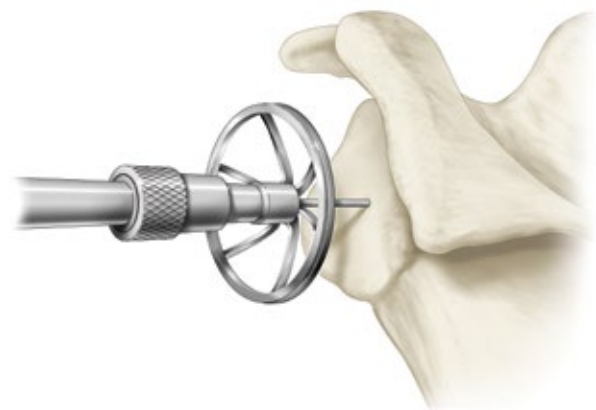

Figure 21
Ream the Glenoid

Table 1

Color-coded Reamers and Trials	
Size	Color of Reamer and Trials
38	Blue
42	Yellow
46	Orange

The reamer tip is placed into the drilled pilot hole and the glenoid is sequentially reamed until any pre-identified glenoid erosions are corrected and the glenoid surface has been fully contoured (*Figure 19*). Reaming begins with the Reverse Shoulder Starter Reamer and progresses to the 38mm, 42mm and 46mm sizes based upon the anticipated size of the glenosphere. **It is critical to ream to the size of the largest potential glenosphere that the surgeon might use to ensure that the glenosphere will fit on the face of the glenoid without peripheral bony impingement (i.e. the glenoid plate will already be fixed to the glenoid and upsizing the glenosphere during trialing will not be possible if the corresponding reaming has not already been performed).** Reamers are available in color-coded sizes that correspond to the two sizes of Glenospheres as described in *Table 1*.

Cannulated Reamers

If using the Cannulated Reamers, align the **inferior aspect** of the **Modular Glenoid Plate Drill Guide** with the **inferior aspect** of the native glenoid bone. Drill the 0.079 inch K-wire through the 2mm pilot hole of the Modular Glenoid Plate Drill Guide. Connect the appropriately sized Modular Cannulated Reamer (note that the reamers are color coded) to the Modular Driver (*Figure 20*).

Reaming begins with the Reverse Shoulder Starter Reamer and progresses to the 38mm, 42mm and 46mm sizes based upon the anticipated size of the glenosphere. Sequentially ream the glenoid over the central K-wire until any pre-identified glenoid erosions are corrected and the glenoid surface has been fully contoured (*Figure 21*).

It is critical to ream to the size of the largest potential glenosphere that the surgeon might use to ensure that the glenosphere will fit on the face of the glenoid without

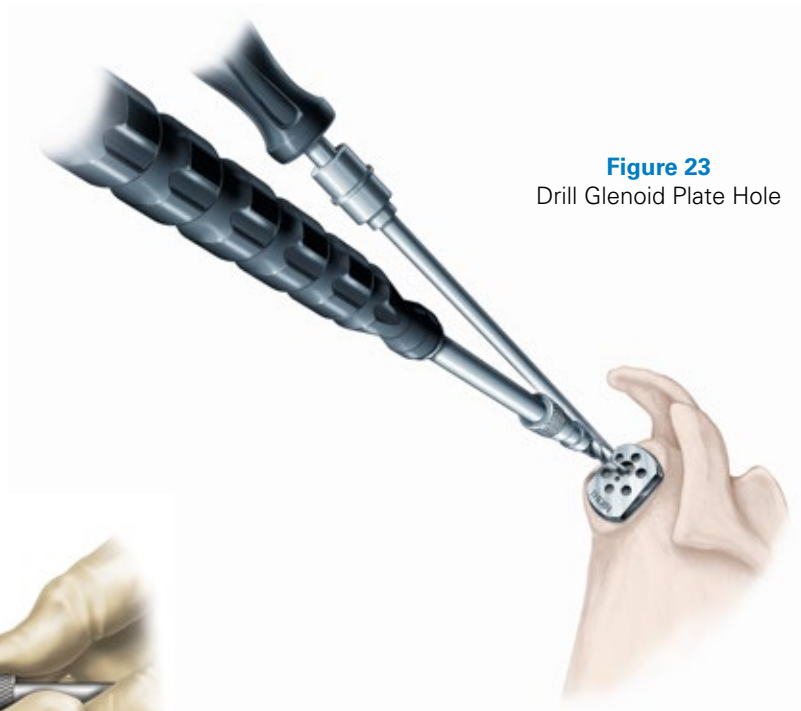

Figure 23
Drill Glenoid Plate Hole



Figure 22
Connect Modular Glenoid Plate
Drill to Glenoid Driver



Figure 24
Assemble Glenoid Plate
with Bone Graft

peripheral bony impingement (i.e. the glenoid plate will already be fixed to the glenoid and upsizing the glenosphere during trialing will not be possible if the corresponding reaming has not already been performed). Reamers are available in color-coded sizes that correspond to the two sizes of Glenspheres as described in *Table 1* below.

Drill Cage Hole through Drill Guide

After reaming has been completed, the **inferior aspect** of the Modular Glenoid Plate Drill Guide is realigned with the **inferior aspect** of the glenoid. Connect the **Modular Glenoid Plate Drill** to the **Modular Driver** to prepare the glenoid for the cage hole of the Glenoid Plate (*Figure 22 and 23*). The Glenoid Plate Drill is 7.3mm in diameter. The Glenoid Plate cage is tapered and varies in diameter between 7.5mm at its end to 8.1mm where it joins the back of the Glenoid Plate.

Note: *Modular Cannulated Center Peg Drill Option: After reaming over the 0.079 inch K-wire, drill over the existing K-wire with the Modular Cannulated Center Peg Drill.*

Bone Graft for Glenoid Plate

Two options exist for placing bone graft in the glenoid plate's cage (*Figure 24*).

1. Using the **Glenoid Plate Coring Reamer** to create a 6mm autograft bone column from the humeral head, or other suitable location as deemed appropriate by the surgeon, and inserting the bone column directly into the cage.
2. Placing allograft (e.g. 1cc of either Optecure® with ccc or Optecure in a syringe) or morsalized autograft manually into the cage.

Note: *Take care to prevent bone graft from getting on the screw-hole threads as this could prevent adequate screw engagement.*

DETAILED OPERATIVE TECHNIQUE

FRACTURE REVERSE SURGICAL APPROACH



Figure 25
Insert Glenoid Plate

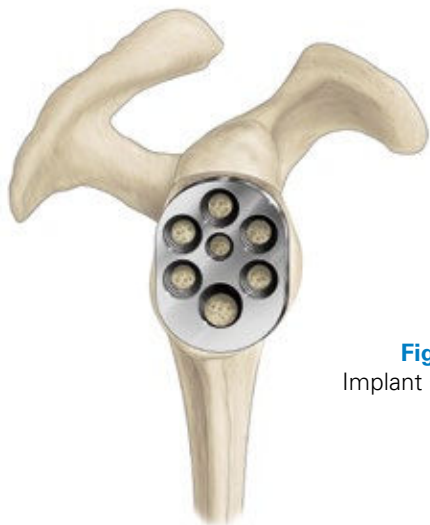

Figure 26
Implant Glenoid Plate

Figure 27
Drill Inferior Hole



Figure 28
Implant Screw

Implanting the Glenoid Plate

Once the cage hole is drilled, the Glenoid Plate is attached to the **Glenoid Plate Inserter** and the Glenoid Plate is press fit into position taking care to respect the correct rotational orientation (**i.e. the plate should align with the superior/inferior axis of the glenoid**) (*Figure 25*). The Inserter connects to the **bottom half** of the Glenoid Plate such that the central pin aligns with the threaded central hole and the peripheral legs connect to the bottom peripheral holes of the Glenoid Plate.

Four of the six potential screw locations that will provide optimal fixation and support of the glenoid plate are identified. Primary reverse shoulders will most typically use the superior and three inferior holes based on the anatomy of the native glenoid. The two peripheral holes on the superior part of the plate are intended for revision cases in which the native glenoid bone is compromised. However,

each case should be individualized and the six holes provide the surgeon with additional options to maximize fixation of the Glenoid Plate (*Figure 26*). Four holes should be drilled using the **Adjustable Angle Drill Guide** and the **3.2mm Drill** (*Figure 27*), taking note of the depth of each hole using either the color-coded drill or the traditional depth guide. Each hole allows 30 degrees of angular variability so the orientation of the screws can be selected to maximize purchase.

Note: *The central cage of the glenoid plate limits the angular variability to 20 degrees for converging anterior, posterior and superior screws.*

The inferior screw should track along the inferior scapular neck and the superior screw should be targeted to track along the base of the coracoids (*Figure 28*). The anterior and posterior screws should be inserted where the surgeon feels the best bone purchase can be achieved, taking note not to drill into the central cage of the Glenoid Plate.

Table 2

Compression Screws		
Length (mm)	Diameter (mm)	Color-code
18	4.5	White
22	4.5	Black
26	4.5	Orange
30	4.5	Blue
34	4.5	Red
38	4.5	Green
42	4.5	Yellow
46	4.5	Purple

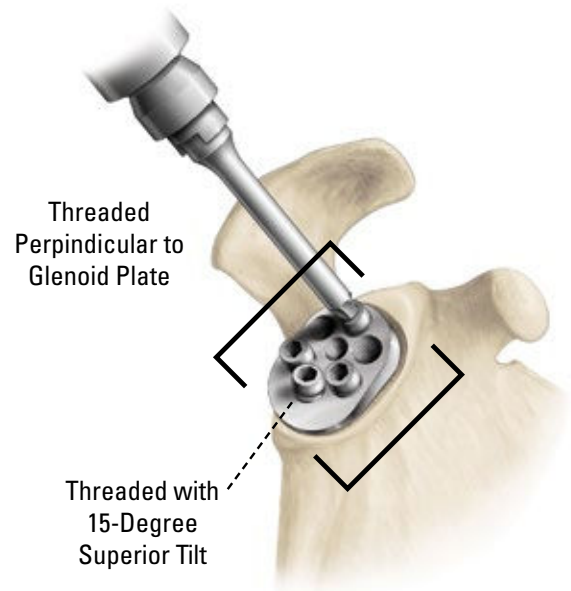

Figure 29
Locking Cap

The 4.5mm **Compression Screws** are provided in lengths between 18mm and 46mm, in 4mm increments. The appropriately sized Compression Screws (*Table 2*) are inserted into the drilled holes to achieve fixation and compression of the Glenoid Plate to the glenoid. If power is used to initially insert the screws, caution should be taken to perform the final seating by hand. This will maximize fixation. A **Ratcheting Screw Drive** is included in the instrument set to facilitate the placement and tightening of the screws.

After all Compression Screws are tightened by hand, as deemed appropriate by the orthopaedic surgeon, the surgeon should insert the **Locking Caps** into each screw hole. This will lock each Compression Screw and prevent the screws from backing out. **Each Locking Cap is inserted perpendicular to the plate with the exception of the inferior one, which must be threaded at a 15-degree superior tilt** (*Figure 29*).

Inserting the Glenosphere Trial

Attaining adequate glenoid exposure is critical for this step, especially posterior glenoid exposure. The Posterior Glenoid Retractor included in the set can help provide the posterior clearance necessary to implant the **Glenosphere**.

The appropriately sized Glenosphere is defined by implanting the largest one that can be inserted based upon exposure and the coracoacromial arch anatomy (ensuring that it was reamed up to that size during the glenoid reaming step). **Take note that unlike circular baseplates, the anatomical shape of the Equinox Glenoid Plate mandates that the Glenosphere can only fit in one specific orientation (i.e. the superior/inferior axis of the glenoid).**

Attach the spring handle to the apical hole of the glenosphere so that rotational control is achieved. Place the pilot tip of the inserter slide through the spring handle and glenosphere

DETAILED OPERATIVE TECHNIQUE

FRACTURE REVERSE SURGICAL APPROACH

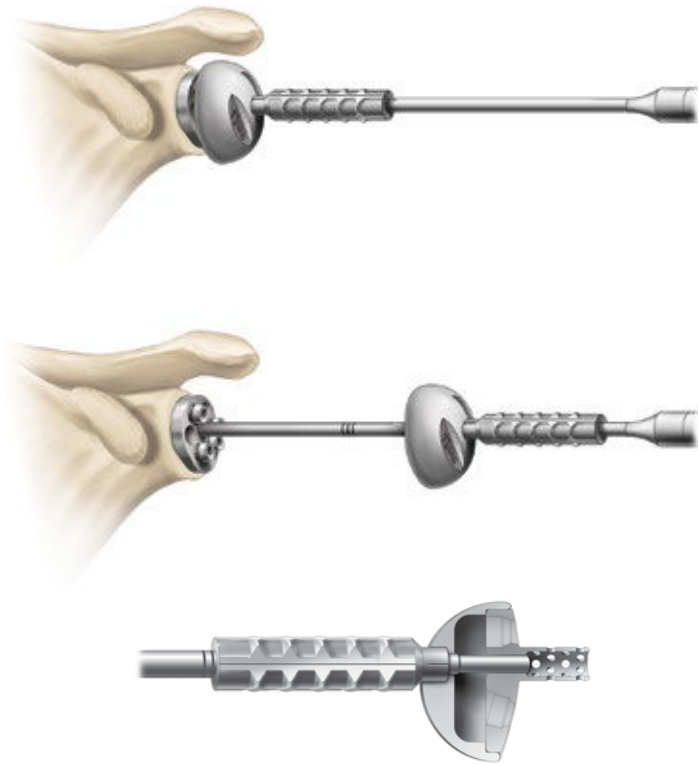

Figure 30a

Glenosphere Inserter Slide and Spring Handle

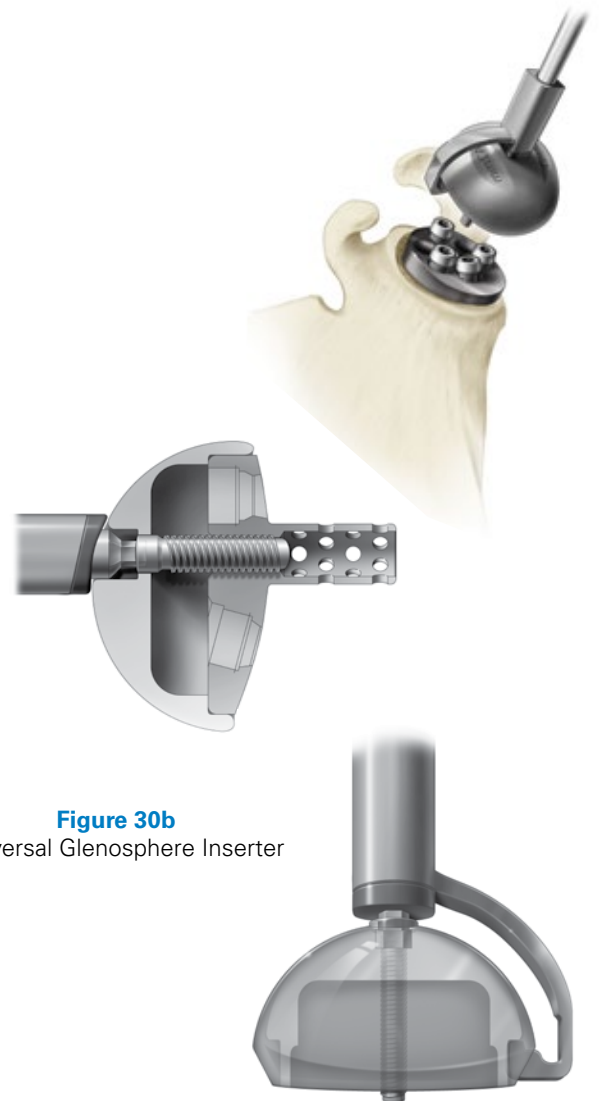

Figure 30b

Universal Glenosphere Inserter

and into the baseplate. Three circumferential laser marks (corresponding to the three sizes of glenospheres) are included on the slide to indicate the glenosphere has been fully seated on the baseplate. Additional alignment laser marks are included to help the surgeon maintain the correct orientation of the glenosphere. Maintain digital pressure on the glenosphere while removing the inserter (*Figure 30a*).

Universal Glenosphere Inserter Clamp: To engage the glenosphere, use the hook to grab the anterior cavity of the glenosphere so that rotational control is achieved.

The Glenosphere Locking Screw may be inserted prior to engaging the handle or it can be inserted through the handle after it is in place. Once the inserter is attached to the glenosphere, insert the hex drive through the handle to engage the tip of the locking screw. This will hold the glenosphere in place during insertion. The glenosphere can then be maneuvered onto the Glenoid Plate by using the Glenosphere Locking Screw as a guide to the central hole and to ensure it is properly aligned relative to the bone cage. When the glenosphere is fully seated, drive the screw until it locks the assembly together (*Figure 30b*).

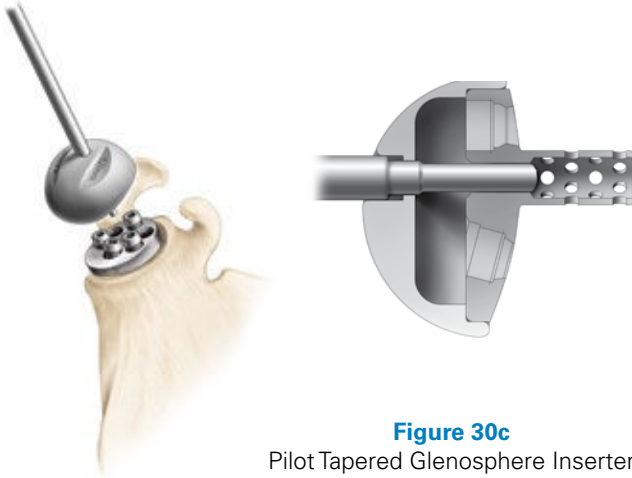

Figure 30c
Pilot Tapered Glenosphere Inserter

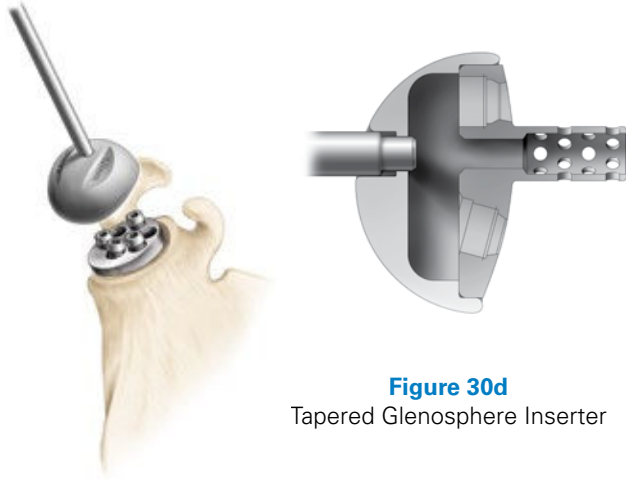

Figure 30d
Tapered Glenosphere Inserter



Figure 31
Glenosphere Locking Screw

Pilot Tapered Glenosphere Inserter: Attach the T-Handle to the inserter. Align the T-Handle in the north/south axis of the glenosphere to ensure that it is properly oriented with the Glenoid Plate. The pilot tip fits into the baseplate to aid in orienting the glenosphere onto the baseplate. Once the glenosphere is seated on the baseplate, apply digital pressure to ensure the glenosphere stays on the baseplate and remove the inserter. Do not attempt to impact the Pilot Glenosphere Inserter once the glenosphere is seated (*Figure 30c*).

Tapered Glenosphere Inserter: Attach the Tapered Glenosphere Inserter in the same manner as the Pilot Glenosphere Inserter. This instrument provides rotational stability and axial control. Since the instrument is cannulated, a 0.062 inch guide wire or K-wire can be inserted into the bone cage of the Glenoid Plate to aid with insertion (*Figure 30d*).

Finally, the Glenosphere Trial is connected to the Glenoid Plate with the Glenosphere Locking Screw to prevent the Glenosphere from disengaging during trial reductions.

Note: When threading the Glenosphere Locking Screw, take note that the hole is not at the apex of the Glenosphere, which can make the screw appear to be going in off axis. The screw is threaded to the baseplate in an orientation that is perpendicular to the baseplate, but this is not perpendicular to the hole in the Glenosphere (*Figure 31*).

DETAILED OPERATIVE TECHNIQUE

FRACTURE REVERSE SURGICAL APPROACH



Figure 32
Ream Humeral Canal

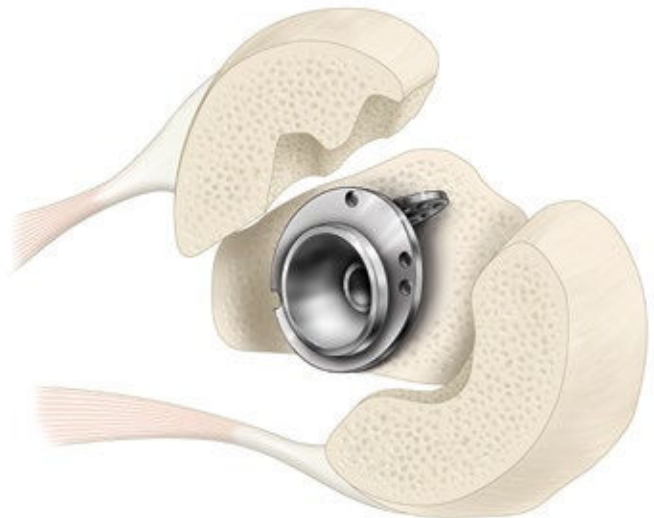

Figure 33
Align Fin to the
Bicipital Groove

HUMERAL PREPARATION

Sequentially ream the intra-medullary canal beginning with the 7mm Fluted Reamer, until endosteal cortical contact is achieved (**Figure 32**). To avoid over-reaming, keep in mind the anticipated stem diameter based on pre-operative templating. When using the 7mm Reamer, the notch in the flutes indicates the appropriate depth to guarantee the stem can fit distally. The top of the flutes should be used as the depth marker for all other sizes. This ensures the stem can be fully seated for the larger sizes (the 8.5mm, 10.5mm and 12.5mm fracture stems are 20mm longer than the 6.5mm).

The use of a cement restrictor is based on personal preference; however, an appropriately sized cement restrictor will improve distribution. If a cement restrictor will be used, it is advantageous to place the cement restrictor in the humeral canal after reaming and before the Fracture Stem Positioning Device is attached to the humerus to avoid interference with the K-wires.

Note: Reaming to the notch on the 7mm Reamer will ensure adequate depth for the distal stem if desired height was difficult to determine preoperatively. All other sizes should be reamed to the top of the flutes.

Fracture Stem Trialing

Select the Fracture Stem Trial based on the last Reamer used. Ensure that the appropriate stem side is chosen (e.g. “Right” or “Left”).

Retroversion—Distal Portion of Bicipital Groove (Visible)

Retroversion is established by aligning the anterior-lateral fin of the Fracture Stem Trial with the posterior aspect of the distal bicipital groove (**Figure 33**). Computational analysis of data from our anatomic study of cadaveric humeri demonstrated that placing the fin in the posterior aspect of the distal bicipital groove established retroversion as accurately as the traditional technique of using a pre-selected fixed angle relative to the epicondylar axis.^{1,2}



Figure 34
Position Trial Stem



Figure 35
Maintain Height



Figure 36
Attach Humeral Tray Trial to the Stem

Retroversion—Distal Portion of Bicipital Groove (Not Visible)

Typically, the distal portion of the bicipital groove is visible but in cases when it is not, the standard technique of retroverting the implant at 20 degrees relative to the forearm should be used. In this case, the surgeon must attach the Primary Stem Inserter to the Fracture Stem Trial and screw in the Retroversion Handle as shown in *Figure 33*. By aligning the Retroversion Handle with the forearm, the Fracture Stem Trial will be placed in 20 degrees of retroversion (*Figure 34*). A mark should be placed on the humeral cortex that corresponds to the anterior-lateral fin of the implant to maintain 20 degrees of retroversion during implantation.

Place the Fracture Stem Trial into the intramedullary canal at the desired height or based on the surgeon's intra operative judgment. Using the Fracture Stem Positioning Device, slide the two pins through the top and bottom suture holes in the anterior-lateral fin of the Fracture Stem Trial. Then place two

K-wires (0.062 inches) into the humeral shaft to stabilize the Fracture Stem Positioning Device to the bone. The goal is to secure the K-wires in the cortical bone so choose the widest holes that still align with the humerus. Selecting a middle row allows the surgeon to make +/- 4mm height adjustments during the trial reduction by sliding the Fracture Stem Positioning Device off the K-wires and repositioning it (*Figure 35*).

Trialing the Humeral Adapter Tray and Liner

The +0mm Humeral Adapter Tray Trial is attached to the humeral stem by threading the Humeral Adapter Tray Captured Screw into the Humeral Stem's screw hole (*Figure 36*) (+10mm is also attached this way). It is critical that the Humeral Adapter Tray be oriented such that the line on the Adapter Tray aligns with the lasermarking on the face of the Platform Fracture Stem. The +5mm trial tray can be added as needed. For a +10mm offset and greater, remove the +0mm Humeral Adapter Tray Trial and insert the +10mm tray trial. To obtain a +15mm offset (special order) and larger, the +5mm tray trial will need to be added.

DETAILED OPERATIVE TECHNIQUE

FRACTURE REVERSE SURGICAL APPROACH



Figure 37
Attach Humeral Liner
Trial to Trial Tray



Figure 38
Remove Liner Trial

Combinations of trays and liners can achieve the following offsets: 0, +2.5, +5.0, +7.5, +10.0, +12.5mm and available by special order +15 and +17.5mm. It is important to note that the assembled humeral component will have a humeral neck angle of 145 degrees because the 145-degree liner adds 12.5 degrees to the stem's 132.5-degree neck angle (**Figure 37**).

If using the 135-Degree Humeral Liner, the assembled humeral component will have a humeral neck angle of 135 degrees because the 135-degree liner adds 2.5 degrees to the stem's 132.5-degree neck angle.

Note: It is important to use the correct humeral liner trial depending on the desired humeral neck angle. The 135-Degree humeral liner trials shall ONLY be used in conjunction with 135-Degree liner implants. The 145-Degree humeral liner trials shall ONLY be used in conjunction with 145-Degree liner implants.

To insert the Humeral Liner Trial into the Trial Tray, the underside asymmetric-connecting feature should be appropriately aligned and the liner/tray trials should be pressed together until the C-spring engages. To disengage

the trials, the tip of the **Humeral Liner Removal Tool** is inserted into the recessed region of the trial tray and the instrument is turned like a key until the spring that connects the Humeral Liner Trials and plate trials is disengaged, thereby freeing the Liner (**Figure 38**).

The stability of the implant is assessed during a trial reduction. The shoulder should be placed through a range of motion to assess the stability of the construct. While each surgeon may have their own system to assess stability, we approach the trial reduction as follows:

1. With reduction and arm by the side, the lateral deltoid and conjoined tendon should be under tension. The expectation is that the reduction should require more distraction to achieve than reduction of non-constrained implants.
2. Forward elevation and abduction should be assessed to determine that the construct is stable and the components do not impinge on bony structures, such as inferior portion of the scapula or the acromion. Note that the potential impingement points may change depending on the humeral liner angle used (145- vs. 135-degrees).



Figure 39

Attach Final Glenosphere to Glenoid Plate

3. Internal and external rotation should be assessed with the humerus at 0 and 90 degrees to assess stability. Although maximal ranges of external rotation may produce some impingement posteriorly, it should not result in instability.
4. With the arm at the side, there should be no evidence of impingement that results in distraction of the implants.

If additional stability is required based upon the trial reduction, constrained liner options are provided in the same offset as the standard liners. While constrained liners will provide better stability, it is important to note they will also reduce the potential range of motion that can be achieved. If tension is inadequate, additional offset can be added up to 12.5mm. If trial components are changed, additional closed reductions and assessments should be performed to confirm that the desired stability has been obtained. In the unusual situation in which the +0mm liner is too tight, the humeral component should be removed and additional bone should be resected using the methods described.

REDUCTION WITH DEFINITIVE IMPLANT

Cementing the Fracture Stem

To remove the Fracture Stem Trial, leave the Fracture Stem Positioning Device attached to the humerus and slide the holding pins out of the suture holes in the anterior-lateral fin. Alternatively, if the Positioning Device is not used, the location of the fin can be marked and the height relative to the holes in the fin can be carefully noted and then reproduced with the definitive stem.

The Humeral Liner Trial, Humeral Adapter Tray Trial and Glenosphere Trial are removed. The final Glenosphere is implanted in the same manner used with the Glenosphere Trial. Impaction of the Glenosphere is not necessary since it is not a Morse taper. The Glenosphere is secured with the Glenosphere Locking Screw, which employs a Spiralock® technology (*Figure 39*).

DETAILED OPERATIVE TECHNIQUE

FRACTURE REVERSE SURGICAL APPROACH



Figure 40
Drill the Pilot Holes for Attaching
Vertical Sutures



Figure 41
Lock Torque-Defining Screw using
the Back Table Assembly

Two drill holes are placed through the humeral cortex into the intra-medullary canal. These holes should be placed approximately 1.5 to 2cm distal to the level of the surgical neck and lateral to the bicipital groove. Two #5 non-absorbable sutures are passed through one drill hole into the intra-medullary canal and then out through the second drill hole (**Figure 40**). These vertical sutures are used for tuberosity fixation. The canal is then irrigated copiously and any loose cancellous bone removed.

The stem, tray and liner can be assembled using the Back Table Assembly first and then placed as a unit into the humerus with cement. The disadvantage of this technique is that further implant trialing is not possible so it should be used when the surgeon is confident about the thickness of the tray and liners based on the previous trialing. The advantage of this technique is that the shoulder can be reduced and the surgeon can begin closing while the cement is hardening.

When using the Back Table Assembly Stand, place the definitive stem into the Back Table, attach the humeral tray

(making certain to align the lasermark on the humeral tray with the mark on the face of the stem) and lock the Torque-Defining Screw (**Figure 41**).

If Back Table Assembly is not used, the final Humeral Liner is attached to the Humeral Tray by orienting the asymmetric connecting features and sliding the lip of the liner under the superior rim of the Humeral Tray. As with the trial insertion, it is important to note that the assembled humeral component will have a humeral neck angle of 145 degrees because the 145 degree Humeral Liner adds 12.5 degrees to the stem's 132.5-degree neck angle.

If using the 135-Degree Humeral Liner, the assembled humeral component will have a humeral neck angle of 135 degrees because the 135-degree Humeral Liner adds 2.5 degrees to the stem's 132.5-degree neck angle.

Note: Please ensure the correct humeral liner implant is chosen, the 135-Degree or 145-Degree. This should match the humeral liner that was used during the trialing period.

Table 3
Impactor Tips

Size	Color of Impactor Tips
38	Blue
42	Yellow
46*	Orange

* special order



Figure 42

Impact Final Humeral Liner onto Humeral Tray



Figure 43

For *in situ* Assembly, Fill the Canal with Cement and Put the Stem in the Canal

Finally, the apical mushroom of the Humeral Liner is engaged to the apical lock of the Humeral Adapter Tray by impacting the Humeral Liner with the appropriately sized **Humeral Liner Impactor Tip** (Table 3). The Humeral Liner should be impacted until it sits flush on the Humeral Adapter Tray (Figure 42). Insert the Fracture Stem into the canal and insert the Fracture Stem Positioning Device's two holding pins through the top and bottom holes of the stem's anterior-lateral fin. Ensure the two sutures in the humeral shaft remain mobile and that no cement hardens in the posterior suture handle or medial cerclage suture hole. This will ensure that the prosthesis is inserted at the same height and version as the Fracture Stem Trial. Alternatively, if the Positioning Device is not used, the location of the fin can be marked and the height relative to the holes in the fin can be noted and then reproduced with the definitive stem. Formal cement pressurization is avoided to decrease the possibility of humeral-shaft fracture. The intra-medullary canal should

be packed with a sponge to obtain adequate drying before cementing. Cement is mixed and injected into the canal with a cement gun. At this point, the sutures should be preloaded into the stem following the technique outlined previously. Emphasis should be placed on reattaching the greater tuberosity as these muscles are the only source for external rotation. At this point, the humeral component should be reduced onto the Glenosphere. Range of motion and stability should be assessed to confirm the findings from the trial reduction. Once this assessment has been made, closure can be performed. Alternatively, *in situ* assembly may be used if the surgeon wishes to retain the ability to trial using the definitive implant. In this case, insert the Fracture Stem into the canal and insert the Fracture Stem Positioning Device's two holding pins through the top and bottom holes of the stem's anterior-lateral fin (Figure 43).

DETAILED OPERATIVE TECHNIQUE

FRACTURE REVERSE SURGICAL APPROACH

The final Humeral Adapter Tray is attached to the Humeral Stem using the Reverse Torque-Defining Screw (**Figure 44**). It is critical that the Humeral Adapter Tray be oriented properly, which requires aligning the indicator mark on the tray with the lasermark on the face of the stem. The plate is locked to the stem by applying 11 N*m torque to the Screw with the supplied driver while countering the torque to the arm with the **Reverse Shoulder Modular Replicator Handle**. The superior portion of the Screw will disengage when 11 N*m is reached (and will remain in the Screw Drive, both of which are disposable).

Note: *In situ assembly is recommended if the height of the stem cannot be definitively determined with the trial.*

CLOSURE

DELTOPECTORAL CLOSURE

Depending on surgeon preference, a drain may be used because of the relatively large dead-space and the potential for hematoma formation. The use of a drain will limit the risk of hematoma formation. The deltopectoral interval is closed followed by closure of the subcutaneous tissue and the skin. The upper extremity is then placed in a sling and swathe.

SUPERIOR-LATERAL CLOSURE

A drain should be inserted to minimize the risk of post-operative hematoma formation. The anterior deltoid should be repaired directly to the anterior acromion with #2 non-absorbable sutures passed through drill holes. The split between the anterior and middle deltoid should be repaired with absorbable sutures. The subcutaneous tissue layer is then closed, followed by the skin closure. The upper extremity is then placed in a sling and swathe.

Radiographs are usually obtained in the operating room to document the position and alignment of the implants. The specific views obtained are based upon surgeon preference.

GLENOSPHERE REMOVAL

If the Glenosphere needs to be removed, the removal instrument can be used to hook into the anterior and posterior recesses on the underside of the Glenosphere to lever it off of the baseplate (**Figure 45**).

POST-OPERATIVE REHABILITATION

The rehabilitation program can be carefully started three weeks post-operatively. All patients should begin active range of motion of the elbow, wrist and hand. Range of motion of the shoulder consists of passive and active forward elevation, external rotation based on the intra-operative assessment and internal rotation to the chest wall. Patients should be instructed to perform these exercises five to six times per day for short periods of up to 10 minutes each session.



Figure 44

Attach Humeral Adapter Tray and Lock Reverse Torque-Defining Screw



Figure 45

Remove the Glenosphere

REVISING A HEMIARTHROPLASTY TO A REVERSE

DETAILED OPERATIVE TECHNIQUE

SURGICAL APPROACH



Figure 46

Remove the Humeral Head



Figure 47

Remove the Replicator Plate Tool

It is very important that caregivers do not pull up on the operated arm of the patient in an effort to assist the patient from bed or a chair as this might cause dislocation.

The sling is discontinued between two and six weeks. A longer period of sling use is indicated if there is concern about the stability of the joint. When the sling is discontinued, internal rotation behind the back can be started. Gentle resistive strengthening of the deltoid begins 10-12 weeks post-operatively. When the sling is removed, the patient is instructed to increase use of the upper extremity for activities of daily living.

REVISING A HEMIARTHROPLASTY TO A REVERSE

Gaining exposure to the Glenoid after a hemiarthroplasty, while rarely easy, is facilitated with the Equinoxe System's removable Replicator Plate. Using the Head Removal Tool, lever the head off the Replicator Plate (*Figure 46*).

When the Torque-Defining Screw was initially torqued, the portion that snapped off left a square that can be used to remove the screw. Attach the Torque-Defining Screw Removal Instrument to the T-handle and loosen the screw (*Figure 47*).

The Replicator Plate can now be removed and discarded. Refer to Section 2: Reverse Shoulder Arthroplasty for detailed Reverse Shoulder technique.

IMPLANT LISTING

Catalog Number

Part Description

Fracture Stems

304-21-07	Humeral Stem, Fracture, Left, 6.5mm
304-21-09	Humeral Stem, Fracture, Left, 8.5mm
304-21-11	Humeral Stem, Fracture, Left, 10.5mm
304-21-13	Humeral Stem, Fracture, Left, 12.5mm
304-22-07	Humeral Stem, Fracture, Right, 6.5mm
304-22-09	Humeral Stem, Fracture, Right, 8.5mm
304-22-11	Humeral Stem, Fracture, Right, 10.5mm
304-22-13	Humeral Stem, Fracture, Right, 12.5mm
304-23-07	Humeral Long Stem, Fracture, Left, 6.5x200mm
304-24-07	Humeral Long Stem, Fracture, Right, 6.5x200mm



HEMIARTHROPLASTY IMPLANTS

Humeral Heads

310-01-38	Humeral Head, Short, 38mm
310-01-41	Humeral Head, Short, 41mm
310-01-44	Humeral Head, Short, 44mm
310-01-47	Humeral Head, Short, 47mm
310-01-50	Humeral Head, Short, 50mm
310-01-53	Humeral Head, Short, 53mm
310-02-38	Humeral Head, Tall, 38mm
310-02-41	Humeral Head, Tall, 41mm
310-02-44	Humeral Head, Tall, 44mm
310-02-47	Humeral Head, Tall, 47mm
310-02-50	Humeral Head, Tall, 50mm
310-02-53	Humeral Head, Tall, 53mm
310-03-47	Humeral Head, Expanded, 47mm
310-03-50	Humeral Head, Expanded, 50mm
310-03-53	Humeral Head, Expanded, 53mm



Replicator Plate Kit

300-21-00	Fixed Angle Replicator Plate Kit, 0mm
-----------	---------------------------------------



**Catalog
Number Part Description**

FRACTURE REVERSE IMPLANTS

Humeral Adapter Trays

322-10-00	Reverse Shoulder, Humeral Adapter Tray, +0mm
322-10-05	Reverse Shoulder, Humeral Adapter Tray, +5mm
322-10-10	Reverse Shoulder, Humeral Adapter Tray, +10mm
322-10-15	Reverse Shoulder, Humeral Adapter Tray, +15mm*



Glenosphere Locking Screw

320-15-05	Reverse Shoulder, Glenosphere Locking Screw
-----------	---



145-Degree Humeral Liners

322-38-00	145-Degree PE 38mm Humeral Liner, +0
322-38-03	145-Degree PE 38mm Humeral Liner, +2.5
322-38-10	145-Degree PE 38mm Humeral Liner, Constrained, +0
322-38-13	145-Degree PE 38mm Humeral Liner, Constrained, +2.5

322-42-00	145-Degree PE 42mm Humeral Liner, +0
322-42-03	145-Degree PE 42mm Humeral Liner, +2.5
322-42-10	145-Degree PE 42mm Humeral Liner, Constrained, +0
322-42-13	145-Degree PE 42mm Humeral Liner, Constrained, +2.5

322-46-00	145-Degree PE 46mm Humeral Liner, +0*
322-46-03	145-Degree PE 46mm Humeral Liner, +2.5*
322-46-10	145-Degree PE 46mm Humeral Liner, Constrained, +0*
322-46-13	145-Degree PE 46mm Humeral Liner, Constrained, +2.5*



135-Degree Humeral Liners**

324-38-00	135-Degree PE 38mm Humeral Liner, +0**
324-38-03	135-Degree PE 38mm Humeral Liner, +2.5**
324-38-10	135-Degree PE 38mm Humeral Liner, Constrained, +0**
324-38-13	135-Degree PE 38mm Humeral Liner, Constrained, +2.5**

324-42-00	135-Degree PE 42mm Humeral Liner, +0**
324-42-03	135-Degree PE 42mm Humeral Liner, +2.5**
324-42-10	135-Degree PE 42mm Humeral Liner, Constrained, +0**
324-42-13	135-Degree PE 42mm Humeral Liner, Constrained, +2.5**

324-46-00	135-Degree PE 46mm Humeral Liner, +0**
324-46-03	135-Degree PE 46mm Humeral Liner, +2.5**
324-46-10	135-Degree PE 46mm Humeral Liner, Constrained, +0**
324-46-13	135-Degree PE 46mm Humeral Liner, Constrained, +2.5**



IMPLANT LISTING

Catalog Number

Part Description

Reverse Torque-Defining Screw Kit

320-20-00 Reverse Shoulder, Torque Defining Screw Kit



Glenospheres

320-06-38 Reverse Shoulder, Glenosphere, 38mm

320-06-42 Reverse Shoulder, Glenosphere, 42mm

320-06-46 Reverse Shoulder, Glenosphere, 46mm*



Compression Screw/Locking Cap Kits

320-20-18 Reverse Shoulder, Compression Screw/Locking Cap Kit, 4.5 x 18mm, White

320-20-22 Reverse Shoulder, Compression Screw/Locking Cap Kit, 4.5 x 22mm, Black

320-20-26 Reverse Shoulder, Compression Screw/Locking Cap Kit, 4.5 x 26mm, Orange

320-20-30 Reverse Shoulder, Compression Screw/Locking Cap Kit, 4.5 x 30mm, Blue

320-20-34 Reverse Shoulder, Compression Screw/Locking Cap Kit, 4.5 x 34mm, Red

320-20-38 Reverse Shoulder, Compression Screw/Locking Cap Kit, 4.5 x 38mm, Green

320-20-42 Reverse Shoulder, Compression Screw/Locking Cap Kit, 4.5 x 42mm, Yellow

320-20-46 Reverse Shoulder, Compression Screw/Locking Cap Kit, 4.5 x 46mm, Purple



GLENOID PLATE

320-15-01 Reverse Shoulder, Glenoid Plate



* Special order.

INSTRUMENT LISTING

**Catalog
Number**

Part Description

STANDARD PLATFORM FRACTURE INSTRUMENTS

301-03-10	Retroversion Handle	
301-07-10	Equinox Stem Inserter/Extractor	
301-07-30	T-Handle	
301-10-10	Torque Defining Screw Removal Instrument	
301-10-00 301-10-35	Modular Anatomic Replicator Handle Modular Anatomic Replicator Fork	
301-15-07 301-15-09 301-15-11 301-15-13	Manual Fluted Reamer, 7mm Manual Fluted Reamer, 9mm Manual Fluted Reamer, 11mm Manual Fluted Reamer, 13mm	
305-21-00	Fracture Stem Positioning Device	
305-21-07 305-21-09 305-21-11 305-21-13 305-22-07 305-22-09 305-22-11 305-22-13	Humeral Stem Trial, Fracture, Left, 6.5mm Humeral Stem Trial, Fracture, Left, 8.5mm Humeral Stem Trial, Fracture, Left, 10.5mm Humeral Stem Trial, Fracture, Left, 12.5mm Humeral Stem Trial, Fracture, Right, 6.5mm Humeral Stem Trial, Fracture, Right, 8.5mm Humeral Stem Trial, Fracture, Right, 10.5mm Humeral Stem Trial, Fracture, Right, 12.5mm	
301-25-00	Fixed Angle Replicator Plate Trial	

INSTRUMENT LISTING

Catalog Number

Part Description

HEMIARTHROPLASTY INSTRUMENTS

311-01-38 Humeral Head Trial, Short, 38mm
311-01-41 Humeral Head Trial, Short, 41mm
311-01-44 Humeral Head Trial, Short, 44mm
311-01-47 Humeral Head Trial, Short, 47mm
311-01-50 Humeral Head Trial, Short, 50mm
311-01-53 Humeral Head Trial, Short, 53mm



311-02-38 Humeral Head Trial, Tall, 38mm
311-02-41 Humeral Head Trial, Tall, 41mm
311-02-44 Humeral Head Trial, Tall, 44mm
311-02-47 Humeral Head Trial, Tall, 47mm
311-02-50 Humeral Head Trial, Tall, 50mm
311-02-53 Humeral Head Trial, Tall, 53mm

311-03-47 Humeral Head Trial, Expanded, 47mm
311-03-50 Humeral Head Trial, Expanded, 50mm
311-03-53 Humeral Head Trial, Expanded, 53mm

311-05-01 Head Removal Tool



311-07-05 Impactor



311-07-07 Humeral Head Impactor Tip



REVERSE SHOULDER INSTRUMENTS

311-01-10 132.5-degree, Fixed Angle Cutting Guide



315-25-00 Modular Glenoid Driver













315-27-60 Modular Center Peg/Keel Drill



315-27-63 Modular Cannulated Center Peg Drill



INSTRUMENT LISTING

Catalog Number	Part Description	
321-01-25	Glenosphere Inserter	
321-01-26	Pilot Glenosphere Inserter	
321-01-27	Glenosphere Inserter Slide	
321-01-28	Glenosphere Inserter Spring Handle	
321-01-29	Universal Glenosphere Inserter Clamp	
321-01-38	Glenosphere Trial, 38mm	
321-01-42	Glenosphere Trial, 42mm	
321-01-46	Glenosphere Trial, 46mm*	
321-02-15	Glenosphere Removal Hook	
321-07-05	Impactor Handle	
321-07-10	Glenoid Plate Coring Reamer	
321-07-38	Humeral Liner Impactor Tip, 38mm	
321-07-42	Humeral Liner Impactor Tip, 42mm	
321-07-46	Humeral Liner Impactor Tip, 46mm*	
321-10-00	Humeral Adapter Tray Trial Assembly, +0	
321-10-05	Humeral Adapter Tray Trial Assembly, +5	
321-10-11	Humeral Adapter Tray Trial Assembly, Captured Screw, +10	
301-10-00	Modular Anatomic Replicator Handle	
321-10-35	Reverse Shoulder Modular Replicator Handle	

* Special order.

INSTRUMENT LISTING

**Catalog
Number**

Part Description

321-15-22 Back Table Frame
305-15-00 Back Table Fracture Stem Insert



321-15-30 Modular Glenoid Plate Drill Guide, Left, Superior Lateral
321-15-31 Modular Glenoid Plate Drill Guide, Right, Superior Lateral
321-15-32 Modular Glenoid Plate Drill Guide, Left, Deltpectoral
321-15-33 Modular Glenoid Plate Drill Guide, Right, Deltpectoral



321-15-04 Adjustable Angle Drill Guide



321-20-00 Reverse Drill Kit
321-15-06 Drill, 2.0mm **
321-15-07 Drill, 3.2mm **



321-15-08 Hex Screwdriver, 3.5mm



321-15-09 Glenoid Screw Depth Gauge



321-15-11 Humeral Liner Removal Tool



321-15-13 Glenoid Plate Inserter/Impactor



321-25-01 Modular Reverse Pilot-Tip Starter Reamer
321-25-38 Modular Reverse Pilot-Tip Reamer, 38mm
321-25-42 Modular Reverse Pilot-Tip Reamer, 42mm
321-25-46 Modular Reverse Pilot-Tip Reamer, 46mm*



321-35-01 Modular Reverse Cannulated Starter Reamer
321-35-38 Modular Reverse Cannulated Reamer, 38mm
321-35-42 Modular Reverse Cannulated Reamer, 42mm
321-35-46 Modular Reverse Cannulated Reamer, 46mm*



* Special order.

** Package sterile in kit 321-20-00.

**Catalog
Number Part Description**

145-Degree Humeral Liner Trials

321-38-00	145-Degree Humeral Liner Trial, 38mm, +0
321-38-03	145-Degree Humeral Liner Trial, 38mm, +2.5
321-38-10	145-Degree Humeral Liner Trial, 38mm, Constrained, +0
321-38-13	145-Degree Humeral Liner Trial, 38mm, Constrained, +2.5
321-42-00	145-Degree Humeral Liner Trial, 42mm, +0
321-42-03	145-Degree Humeral Liner Trial, 42mm, +2.5
321-42-10	145-Degree Humeral Liner Trial, 42mm, Constrained, +0
321-42-13	145-Degree Humeral Liner Trial, 42mm, Constrained, +2.5
321-46-00	145-Degree Humeral Liner Trial, 46mm, +0
321-46-03	145-Degree Humeral Liner Trial, 46mm, +2.5
321-46-10	145-Degree Humeral Liner Trial, 46mm, Constrained, +0
321-46-13	145-Degree Humeral Liner Trial, 46mm, Constrained, +2.5

135-Degree Humeral Liner Trials

OPTIONAL KIT: OPT-321LNR135 (Includes all liners listed below)**

Small Reverse 135-Degree Humeral Liner Trials

325-36-00	135-Degree Humeral Liner Trial, 36mm, +0**
325-36-03	135-Degree Humeral Liner Trial, 36mm, +2.5**
325-36-10	135-Degree Humeral Liner Trial, 36mm, +0, Constrained**
325-36-13	135-Degree Humeral Liner Trial, 36mm, +2.5, Constrained**
325-40-00	135-Degree Humeral Liner Trial, 40mm, +0**
325-40-03	135-Degree Humeral Liner Trial, 40mm, +2.5**
325-40-10	135-Degree Humeral Liner Trial, 40mm, +0, Constrained**
325-40-13	135-Degree Humeral Liner Trial, 40mm, +2.5, Constrained**

Standard 135-Degree Humeral Liner Trials

325-38-00	135-Degree Humeral Liner Trial, 38mm, +0**
325-38-03	135-Degree Humeral Liner Trial, 38mm, +2.5**
325-38-10	135-Degree Humeral Liner Trial, 38mm, +0, Constrained**
325-38-13	135-Degree Humeral Liner Trial, 38mm, +2.5, Constrained**
325-42-00	135-Degree Humeral Liner Trial, 42mm, +0**
325-42-03	135-Degree Humeral Liner Trial, 42mm, +2.5**
325-42-10	135-Degree Humeral Liner Trial, 42mm, +0, Constrained**
325-42-13	135-Degree Humeral Liner Trial, 42mm, +2.5, Constrained**
325-46-00	135-Degree Humeral Liner Trial, 46mm, +0**
325-46-03	135-Degree Humeral Liner Trial, 46mm, +2.5**
325-46-10	135-Degree Humeral Liner Trial, 46mm, +0, Constrained**
325-46-13	135-Degree Humeral Liner Trial, 46mm, +2.5, Constrained**



** Limited order.

INSTRUMENT LISTING

**Catalog
Number**

Part Description

RETRACTORS

317-01-08

Wolfe Retractor



317-20-01

Forked Retractor – Small



317-01-03

Darrach Retractor



317-01-06

Hohmann Retractor



317-01-02

Humeral Head Retractor



317-01-04

Dual Point Glenoid Retractor



317-01-05

Single Point Glenoid Retractor



317-20-03

Deltoid Retractor



REFERENCES

1. **Angibaud L, Zuckerman JD, Flurin PH, Roche C, Wright T.** Reconstructing proximal humeral fractures using the bicipital groove as a landmark. *Clin Orthop Relat Res.* 2007 May; 458:168-74.
2. **Roche C, Flurin PH, Wright T, Crosby LA, Mauldin M, Zuckerman JD.** An evaluation of the relationships between reverse shoulder design parameters and range of motion, impingement, and stability. *J Shoulder Elbow Surg.* 2009 Sep-Oct; 18(5):734-41.

Exactech is proud to have offices and distributors around the globe.
For more information about Exactech products available in your country, please visit www.exac.com

Jacobs® is a registered mark of the Jacobs Chuck Manufacturing Co. and Spiralock® is a registered mark of the Spiralock Corp.

For additional device information, refer to the Exactech Shoulder System—Instructions for Use for a device description, indications, contraindications, precautions and warnings. For further product information, please contact Customer Service, Exactech, 2320 NW 66th Court, Gainesville, Florida 32653-1630, USA. (352) 377-1140, (800) 392-2832 or FAX (352) 378-2617.

Exactech, as the manufacturer of this device, does not practice medicine, and is not responsible for recommending the appropriate surgical technique for use on a particular patient. These guidelines are intended to be solely informational and each surgeon must evaluate the appropriateness of these guidelines based on his or her personal medical training and experience. Prior to use of this system, the surgeon should refer to the product package insert for comprehensive warnings, precautions, indications for use, contraindications and adverse effects.

The products discussed herein may be available under different trademarks in different countries. All copyrights, and pending and registered trademarks, are property of Exactech. This material is intended for the sole use and benefit of the Exactech sales force and physicians. It should not be redistributed, duplicated or disclosed without the express written consent of Exactech. ©2024 Exactech. OPTECH-000049 Rev/B 0124



EXACTECH, INC.
2320 NW 66TH COURT
GAINESVILLE, FL 32653 USA

+1 352.377.1140
+1 800.EXACTECH
+1 352.378.2617 (FAX)
www.exac.com